

# Instructions for Educators & Chaperones

# The Getty Villa

## Ancient Greek and Roman Talk Show

This instruction sheet will help you guide your students at the Getty Villa as they work on the Student Worksheet on the following pages.

### GOALS .....> TIPS .....>

- To identify the unique attributes of a chosen god or goddess from ancient Greek or Roman mythology
- To observe how gods and goddesses were portrayed in art
- To consider relationships between an ancient god or goddess and the modern world
- Briefly look over the activity before beginning and think about where you will need to take the students.
- Ask the students questions and be an active leader!
- Be flexible! If one gallery is occupied, move to another, and then return when the gallery is free.
- The student worksheet DOES NOT have to be completed in any particular order.

### OUTDOORS

To complete the "Ancient Greek and Roman Talk Show" visit activity, groups will find a garden sculpture in the **Outer Peristyle Garden**.

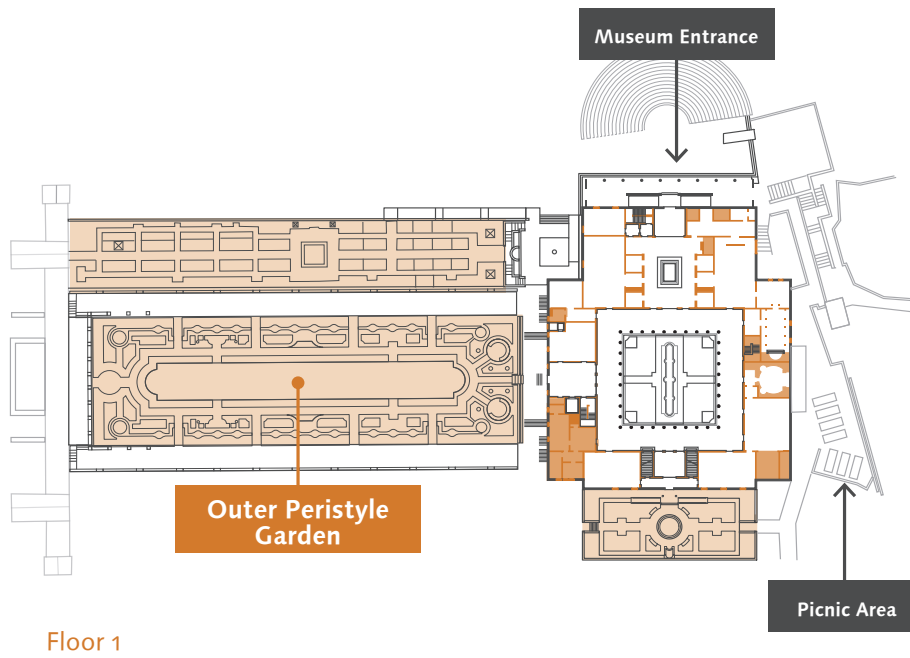

Education

continued .....>

# Instructions for Educators & Chaperones

# The Getty Villa

## Ancient Greek and Roman Talk Show



To complete the "Ancient Greek and Roman Talk Show" visit activity, groups will go to these **galleries** to view the artworks depicting their selected gods or goddesses:

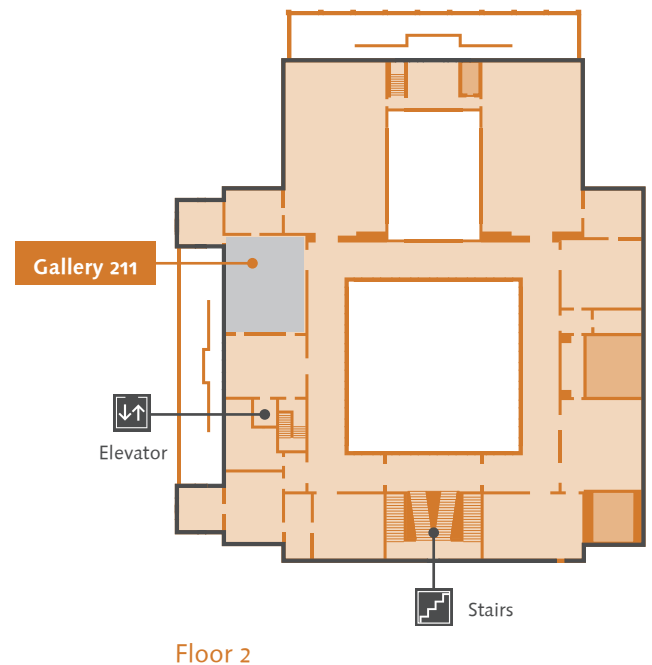
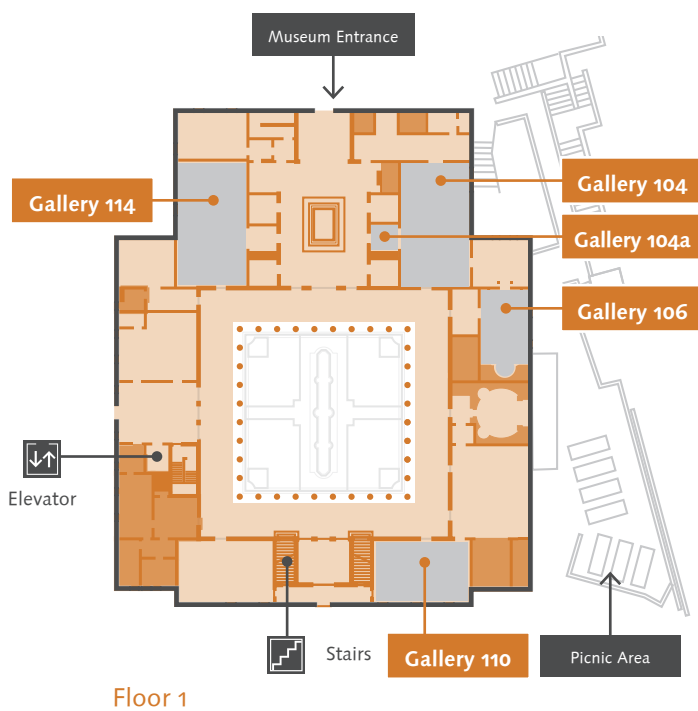

Education

# Student Worksheet

## Ancient Greek and Roman Talk Show

Your Name \_\_\_\_\_

Your God or Goddess \_\_\_\_\_

While visiting the Getty Villa in small chaperoned groups, find and view the object that corresponds to your selected god or goddess.

Use this worksheet (and additional sheets of paper if needed) to document your observations with notes, sketches and/or photographs, and record information you discover about your selected deity.

I. **DESCRIBE** your god or goddess and any unique characteristics:

---

---

II. What do you **NOTICE** about the god or goddess when you see the work of art in person?

---

---

III. Do you **SEE** anything that relates to the information you collected for the pre-visit outline?  
What do you see?

---

---

IV. **HOW** do you think the ancient Greeks and Romans felt toward and worshiped their gods and goddesses?

---

---

# Ancient Greek and Roman Talk Show

V. How might this god or goddess **RELATE** to the modern world?

---

---

Use this space for an image or images of the god or goddess you selected.

You may **SKETCH** and/or **PHOTOGRAPH** the object from one or more angles.



**REMEMBER,**  
no flash photography  
in the galleries!

Education