

Instructions for Educators & Chaperones

The Getty Villa

Architectural Elements of an Ancient Roman Villa (Grades 2-3)

This instruction sheet will help you guide your students at the Getty Villa as they work on the worksheet attached on the following pages.

GOALS> TIPS>

- To explore architectural elements of an ancient villa and learn new vocabulary describing these elements.
- To help students understand functional uses of waterspouts and compare two frescoes.
- Briefly look over the activity before beginning and think about where you will need to take the students.
- Ask the students questions and be an active leader!
- Be flexible! If one gallery is occupied, work on another part of the activity first and then return when the gallery is free.
- These activities DO NOT have to be completed in any particular order.

OUTDOORS

Students look for waterspouts on the fountains in the **East Garden** and the **Herb Garden**. Then they go to the **Outer Peristyle Garden** to look at examples of frescoes.

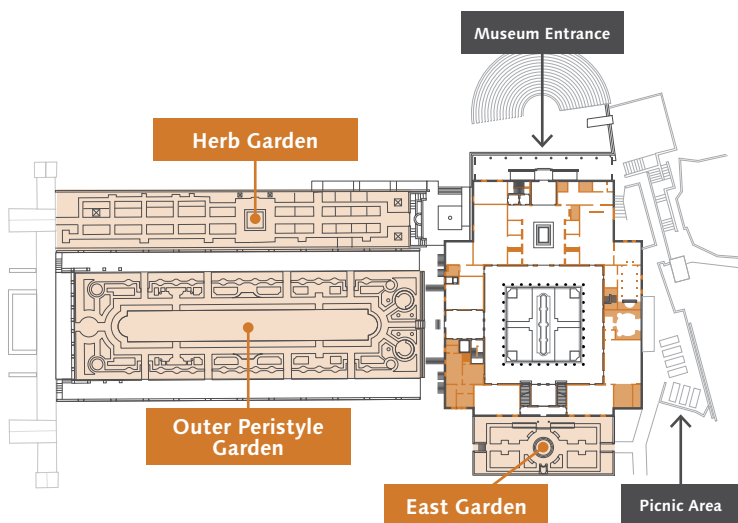

Floor 1

INDOORS

Students will look at examples of waterspouts in the **Animals in Antiquity gallery (Gallery 201c)**. Then they look at a fresco in the **Women and Children in Antiquity gallery (Gallery 207)**.

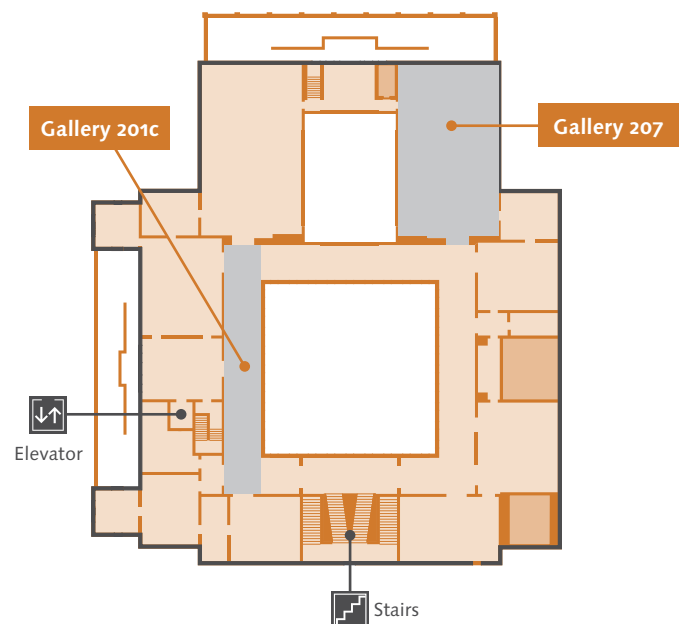

Floor 2

Architectural Elements of an Ancient Roman Villa (Grades 2-3)

Your Name _____

Architecture in ancient times was inspired by nature. Many ancient Roman villas featured architectural elements decorated with designs based on plants, flowers, and animals. The Getty Villa has many examples of these decorations, both inside the Museum galleries and outside in the gardens.



I. **GO TO** the second floor of the Museum and **FIND** the **Animals in Antiquity gallery (Gallery 201c)**.

Can you find a waterspout in this gallery?

Choose one of the waterspouts and answer the questions below.

Where do you see it?

What do you think it was used for?

How do you think it works?

Architectural Elements of an Ancient Roman Villa (Grades 2-3)

II. **GO TO** the second floor of the Museum and find the **Women and Children in Antiquity** gallery (Gallery 207).

What is a fresco?

A painting on fresh, moist plaster (usually on a wall) using pigments dissolved in water.

CHOOSE a fresco in this gallery and list three things you see.

- 1 _____
- 2 _____
- 3 _____



Architectural Elements of an Ancient Roman Villa (Grades 2-3)



OUTDOORS

III. **FOLLOW** your teacher or chaperone to either the **East Garden** or the **Herb Garden**.

Can you **FIND** a waterspout here?

Where do you see it?

How many do you see?

What do you think it is used for?

Why do you think so?

IV. Now, **GO TO** the **Outer Peristyle**. This is the big garden with the long pool in the middle.

Can you **FIND** frescoes here? **CHOOSE** one fresco to look at and list three things you see.

1 _____

2 _____

3 _____

COMPARE the fresco from inside the Museum (Gallery 207) with the fresco you looked at in the **Outer Peristyle**. Do you notice any similarities or differences between them?

Name something that is similar: _____

Name something that is different: _____
