

Getty



TECHNICIAN TRAINING FOR THE CONSERVATION OF MOSAICS

PART 1
THE CONSERVATION OF IN SITU MOSAICS

Documentation of mosaics



Livia Alberti, Ermanno Carbonara, Thomas Roby



Graphic Documentation

Maps and Legends

Elsa Bourguignon 2005, Emanuele Carbonara 2013 © J. Paul Getty Trust

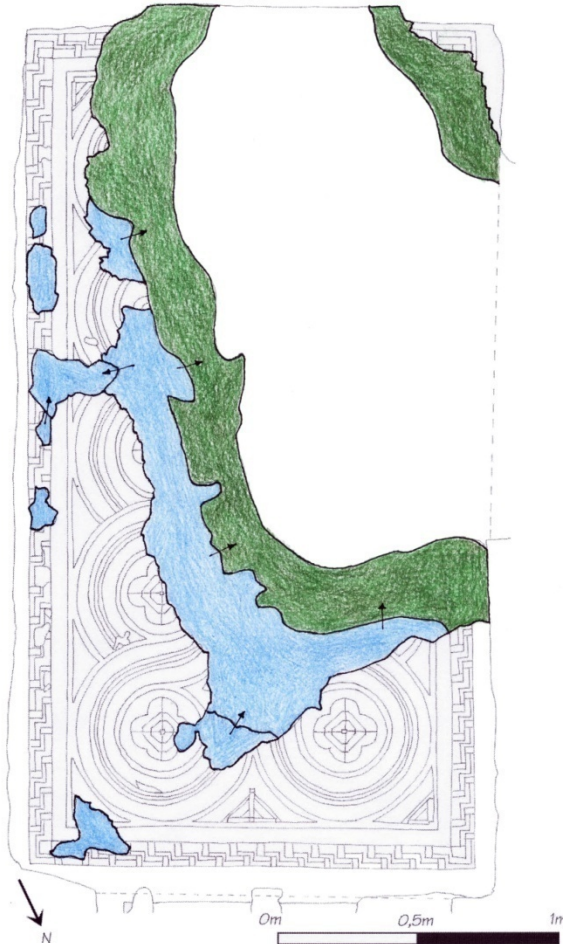

ID: HE H2P 25

BASE MADE ON: June 2005

TITLE: Previous Interventions Map

DATE: June 2005

PREPARED BY: Mohamed Said

LEGEND – PREVIOUS INTERVENTIONS MAP

MOSAIC ID HE, H2P, 25

Mortar repairs

- Infilling of lacunae
- Edging repair
- Outline of each infilling or edging mortar
- Overlapping between mortar layers (new → old)
- Filling of interstices between tesserae
-

Reintegration of lacunae

- Reintegration with tesserae
- Reintegration with :

Detached mosaics

- Outline of the support panels of a detached mosaic re-laid in situ
- Location of the metal reinforcements of the support panels
- Parts detached and stored elsewhere

Other types of interventions

- Reburial outline
- Drainage openings
-
-

PREPARED BY *Mohamed Said*

DATE *June 2005*

Livia Alberti, Elsa Bourguignon, Thomas Roby 2008, 2011, 2013 © J. Paul Getty Trust and Institut National du Patrimoine de Tunisie

Photographic Documentation

Photographs



General photo



Photographic survey



Documentation photo

The maintenance process and its **documentation** through time

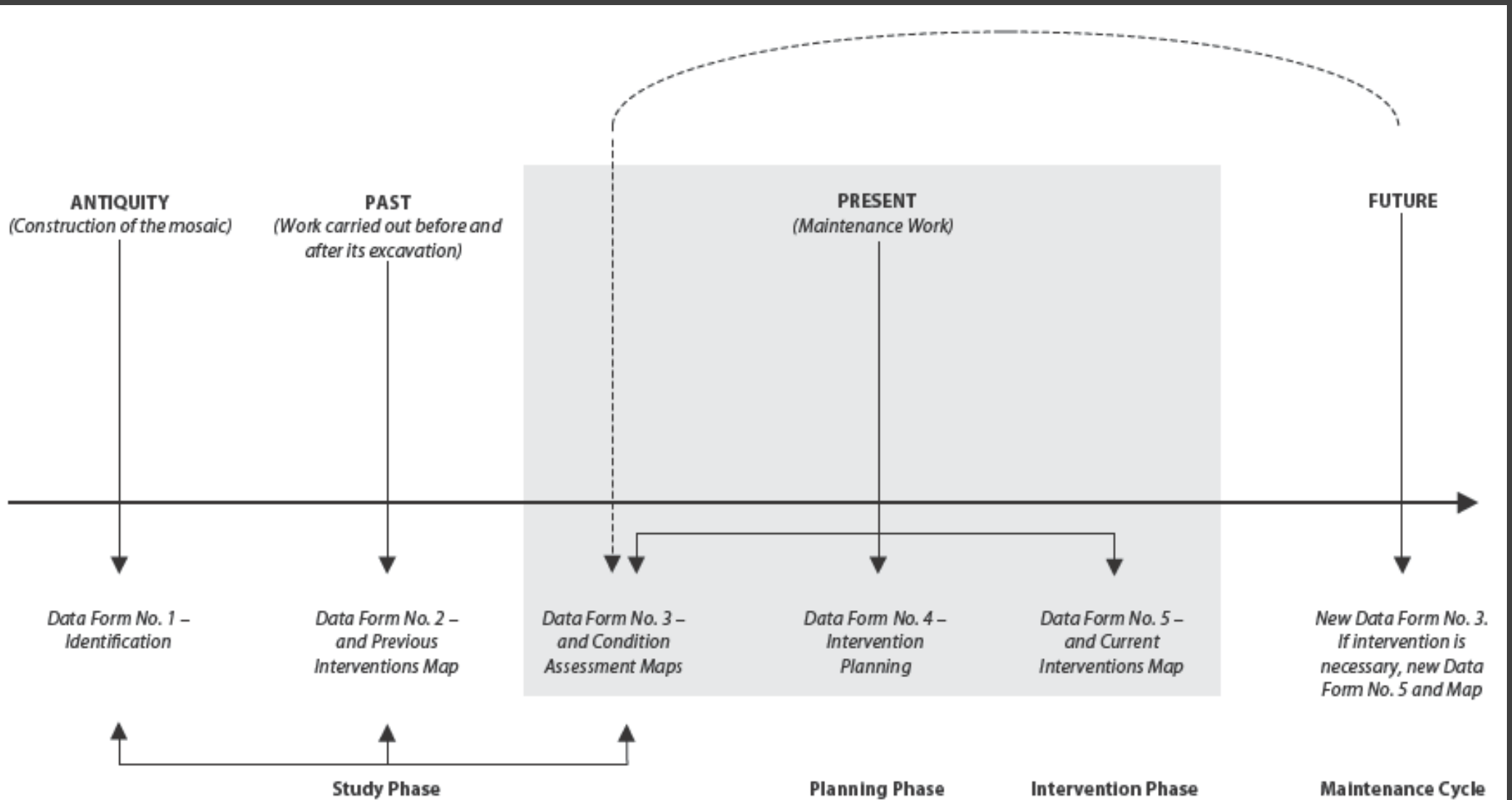

Data Forms

DATA FORM NO. 1 – IDENTIFICATION

STUDY PHASE

MOSAIC ID _____/_____/_____/_____

This form must be completed with the site manager. It should be supplemented by an overall photograph of the mosaic and a plan of the building indicating the location of the room.

SITE

BUILDING

ROOM

SECTIONS, FRAGMENTS OR LEVELS

(Use Arabic numerals for sections, letters for fragments, Roman numerals for levels)

MOSAIC ID

_____/_____/_____/_____
(Abbreviation of the site/ building / room / sections or fragments or levels)

EXISTING DOCUMENTATION ABOUT THE MOSAIC AND ITS CONSERVATION

(References of publications, plans, photographs, drawings and other documents)

DATE OF MOSAIC EXCAVATION:

DIMENSIONS AND NUMBERING OF SECTIONS, FRAGMENTS OR LEVELS

(Use an existing drawing or make a sketch of the mosaic indicating the north and the walls of the room)

GENERAL OBSERVATIONS ON THE CONSTRUCTION TECHNIQUE

(Type of pavement, decoration, materials, colors, tesserae sizes, etc.)

PREPARED BY

DATE

DATA FORM NO. 2 – PREVIOUS INTERVENTIONS

PREVIOUS INTERVENTIONS ON THE MOSAIC

Who repaired: _____

When repaired: _____

Reasons of intervention: _____

Interventions: _____

Materials used: _____

Techniques used: _____

Other observations: _____

DATA FORM NO. 3 – COND

GENERAL INFORMATION

Reference: _____

Location: _____

Coordinates: _____

Scale: _____

Author: _____

Date: _____

Other: _____

DATA FORM NO. 4 – INTE

INTERVENTIONS

Intervention: _____

Date: _____

Location: _____

Reason: _____

Technique: _____

Material: _____

Other: _____

DATA FORM NO. 5 – CURE

INTERVENTIONS

Intervention: _____

Date: _____

Location: _____

Reason: _____

Technique: _____

Material: _____

Other: _____

Livra Alberti, Elisa Bouguignon, Thomas Roby 2008, 2011, 2013 © J. Paul Getty Trust and Institut National du Patrimoine de Tunisie

Data Forms

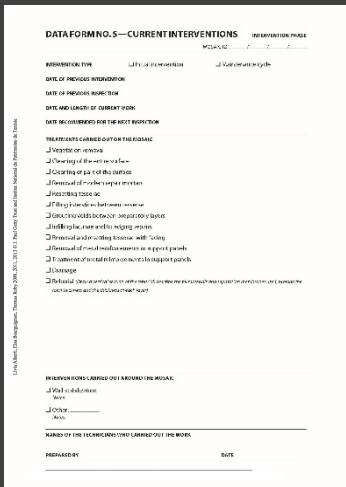

Livra Alberti, Elsa Bouguignon, Thomas Roby 2008, 2011, 2013 © J. Paul Getty Trust and Institut National du Patrimoine de Tunisie

DATA FORM NO. 4—INTERVENTION PLANNING PLANNING PHASE

MOSAIC ID _____ / _____ / _____ / _____

This form must be completed with the site manager.

TIME REQUIRED FOR ORGANIZATION AND COMPLETION OF THE WORK

- Vegetation removal _____ work days for 1 technician
Notes:
- Cleaning _____ work days for 1 technician
Notes :
- Removal of modern repair mortars _____ work days for 1 technician
Notes:
- Resetting tesserae _____ work days for 1 technician
Notes:
- Filling interstices between tesserae _____ work days for 1 technician
Notes:
- Grouting voids between preparatory layers _____ work days for 1 technician
Notes:
- Infilling lacunae and edging repairs _____ work days for 1 technician
Notes:
- Removal and resetting tesserae with facing _____ work days for 1 technician
Notes :
- Removal or treatment of support metal reinforcements _____ work days for 1 technician
Notes:
- Drainage _____ work days for 1 technician
Notes:
- Reburial _____ work days for 1 technician
Notes:
- Documentation _____ work days for 1 technician
Notes:
- Material preparation _____ work days for 1 technician
Notes:
- Other _____ work days for 1 technician
Notes:

TOTAL WORK DAYS FOR 1 TECHNICIAN: _____

Number of days / weeks / months: _____ for number of technicians: _____

- Intervention by a specialist needed on or around the mosaic
Notes:

PREPARED BY _____ DATE _____

Data Forms

Livia Alberti, Elsa Bouguignon, Thomas Roby 2008, 2011, 2013 © J. Paul Getty Trust and Institut National du Patrimoine de Tunisie

DATA FORM NO. 5—CURRENT INTERVENTIONS INTERVENTION PHASE

MOSAIC ID _____ / _____ / _____ / _____

INTERVENTION TYPE Initial intervention Maintenance cycle

DATE OF PREVIOUS INTERVENTION

DATE OF PREVIOUS INSPECTION

DATE AND LENGTH OF CURRENT WORK

DATE RECOMMENDED FOR THE NEXT INSPECTION

TREATMENTS CARRIED OUT ON THE MOSAIC

- Vegetation removal
- Cleaning of the entire surface
- Cleaning of part of the surface
- Removal of modern repair mortars
- Resetting tesserae
- Filling interstices between tesserae
- Grouting voids between preparatory layers
- Infilling lacunae and/or edging repairs
- Removal and resetting tesserae with facing
- Removal of metal reinforcements in support panels
- Treatment of metal reinforcements in support panels
- Drainage
- Reburial *(Draw a vertical section of the reburial: describe the fill materials and separation membranes used, provide the total thickness and the thickness of each layer)*

INTERVENTIONS CARRIED OUT AROUND THE MOSAIC

- Wall stabilization
Notes:
- Other: _____
Notes:

NAMES OF THE TECHNICIANS WHO CARRIED OUT THE WORK

PREPARED BY _____ **DATE** _____

Data Form No. 1 – Identification

DATA FORM NO. 1 – IDENTIFICATION

STUDY PHASE

MOSAIC ID _____/_____/_____/_____

This form must be completed with the site manager. It should be supplemented by an overall photograph of the mosaic and a plan of the building indicating the location of the room.

SITE

BUILDING

ROOM

SECTIONS, FRAGMENTS OR LEVELS

(Use Arabic numerals for sections, letters for fragments, Roman numerals for levels)

MOSAIC ID

_____/_____/_____/_____
(Abbreviation of the site / building / room / sections or fragments or levels)

EXISTING DOCUMENTATION ABOUT THE MOSAIC AND ITS CONSERVATION

(References of publications, plans, photographs, drawings and other documents)

DATE OF MOSAIC EXCAVATION:

DIMENSIONS AND NUMBERING OF SECTIONS, FRAGMENTS OR LEVELS

(Use an existing drawing or make a sketch of the mosaic indicating the north and the walls of the room)

GENERAL OBSERVATIONS ON THE CONSTRUCTION TECHNIQUE

(Type of pavement, decoration, materials, colors, tesserae sizes, etc.)

PREPARED BY

DATE

MOSAIC ID _____ / _____ / _____ / _____

This form must be completed with the site manager. It should be supplemented by an overall photograph of the mosaic and a plan of the building indicating the location of the room.

SITE

BUILDING

ROOM

SECTIONS, FRAGMENTS OR LEVELS

(Use Arabic numerals for sections, letters for fragments, Roman numerals for levels)

MOSAIC ID

_____ / _____ / _____ / _____
(Abbreviation of the site / building / room / sections or fragments or levels)

EXISTING DOCUMENTATION ABOUT THE MOSAIC AND ITS CONSERVATION

(References of publications, plans, photographs, drawings and other documents)

DATE OF MOSAIC EXCAVATION:

DIMENSIONS AND NUMBERING OF SECTIONS, FRAGMENTS OR LEVELS

(Use an existing drawing or make a sketch of the mosaic indicating the north and the walls of the room)

GENERAL OBSERVATIONS ON THE CONSTRUCTION TECHNIQUE

(Type of pavement, decoration, materials, colors, tesserae sizes, etc.)

PREPARED BY

DATE

MOSAIC ID _____ / _____ / _____ / _____

This form must be completed with the site manager. It should be supplemented by an overall photograph of the mosaic and a plan of the building indicating the location of the room.

SITE

BUILDING

ROOM

SECTIONS, FRAGMENTS OR LEVELS

(Use Arabic numerals for sections, letters for fragments, Roman numerals for levels)

MOSAIC ID

_____ / _____ / _____ / _____
(Abbreviation of the site / building / room / sections or fragments or levels)

MOSAIC ID _____ / _____ / _____ / _____

This form must be completed with the site manager. It should be supplemented by an overall photograph of the mosaic and a plan of the building indicating the location of the room.

SITE

BUILDING

ROOM

SECTIONS, FRAGMENTS OR LEVELS

(Use Arabic numerals for sections, letters for fragments, Roman numerals for levels)

MOSAIC ID

_____/_____/_____/_____
(Abbreviation of the site / building / room / sections or fragments or levels)

EXISTING DOCUMENTATION ABOUT THE MOSAIC AND ITS CONSERVATION

(References of publications, plans, photographs, drawings and other documents)

DATE OF MOSAIC EXCAVATION:

DIMENSIONS AND NUMBERING OF SECTIONS, FRAGMENTS OR LEVELS

(Use an existing drawing or make a sketch of the mosaic indicating the north and the walls of the room)

GENERAL OBSERVATIONS ON THE CONSTRUCTION TECHNIQUE

(Type of pavement, decoration, materials, colors, tesserae sizes, etc.)

How to number the divisions of a mosaic

SECTIONS

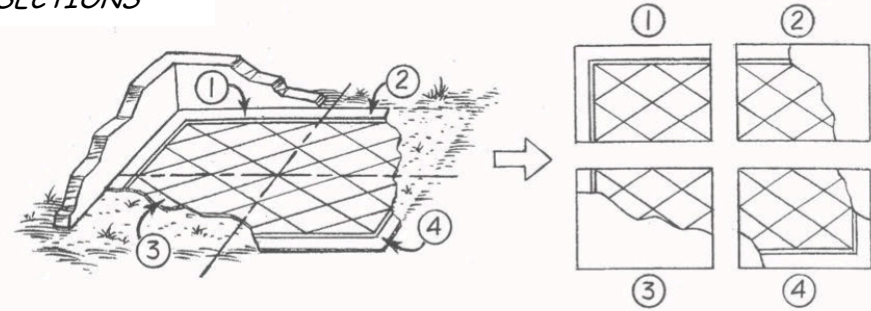

FRAGMENTS

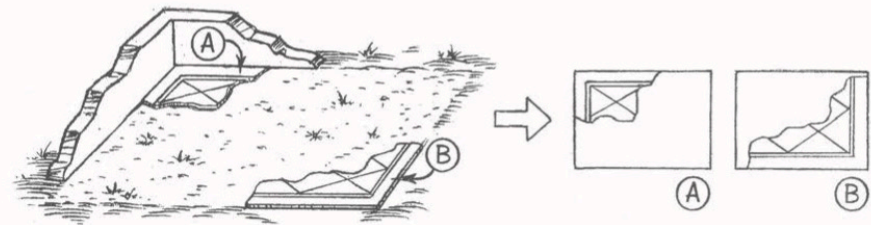

LEVELS

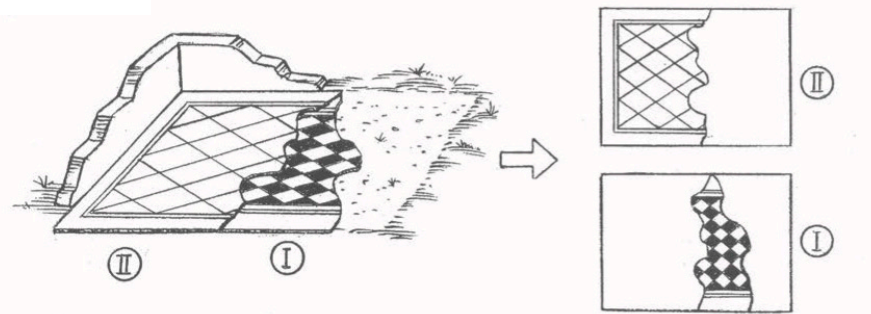

DATA FORM NO. 1 – IDENTIFICATION

STUDY PHASE

MOSAIC ID _____ / _____ / _____ / _____

This form must be completed with the site manager. It should be supplemented by an overall photograph of the mosaic and a plan of the building indicating the location of the room.

SITE

BUILDING

ROOM

SECTIONS, FRAGMENTS OR LEVELS

(Use Arabic numerals for sections, letters for fragments, Roman numerals for levels)

MOSAIC ID

_____ / _____ / _____ / _____
(Abbreviation of the site / building / room / sections or fragments or levels)

EXISTING DOCUMENTATION ABOUT THE MOSAIC AND ITS CONSERVATION

(References of publications, plans, photographs, drawings and other documents)

EXISTING DOCUMENTATION ABOUT THE MOSAIC AND ITS CONSERVATION

(References of publications, plans, photographs, drawings and other documents)

DATE OF MOSAIC EXCAVATION:

DIMENSIONS AND NUMBERING OF SECTIONS, FRAGMENTS OR LEVELS

(Use an existing drawing or make a sketch of the mosaic indicating the north and the walls of the room)

GENERAL OBSERVATIONS ON THE CONSTRUCTION TECHNIQUE

(Type of pavement, decoration, materials, colors, tesserae sizes, etc.)

PREPARED BY

DATE

DATA FORM NO. 1 – IDENTIFICATION

STUDY PHASE

MOSAIC ID _____ / _____ / _____ / _____

This form must be completed with the site manager. It should be supplemented by an overall photograph of the mosaic and a plan of the building indicating the location of the room.

SITE

BUILDING

ROOM

SECTIONS, FRAGMENTS OR LEVELS

(Use Arabic numerals for sections, letters for fragments, Roman numerals for levels)

MOSAIC ID

_____ / _____ / _____ / _____
(Abbreviation of the site / building / room / sections or fragments or levels)

EXISTING DOCUMENTATION ABOUT THE MOSAIC AND ITS CONSERVATION

(References of publications, plans, photographs, drawings and other documents)

DATE OF MOSAIC EXCAVATION:

DATE OF MOSAIC EXCAVATION:

DIMENSIONS AND NUMBERING OF SECTIONS, FRAGMENTS OR LEVELS

(Use an existing drawing or make a sketch of the mosaic indicating the north and the walls of the room)

GENERAL OBSERVATIONS ON THE CONSTRUCTION TECHNIQUE

(Type of pavement, decoration, materials, colors, tesserae sizes, etc.)

PREPARED BY

DATE

DATA FORM NO. 1 – IDENTIFICATION

STUDY PHASE

MOSAIC ID _____ / _____ / _____ / _____

This form must be completed with the site manager. It should be supplemented by an overall photograph of the mosaic and a plan of the building indicating the location of the room.

SITE

BUILDING

ROOM

SECTIONS, FRAGMENTS OR LEVELS

(Use Arabic numerals for sections, letters for fragments, Roman numerals for levels)

MOSAIC ID

_____ / _____ / _____ / _____
(Abbreviation of the site / building / room / sections or fragments or levels)

EXISTING DOCUMENTATION ABOUT THE MOSAIC AND ITS CONSERVATION

(References of publications, plans, photographs, drawings and other documents)

DATE OF MOSAIC EXCAVATION:

DIMENSIONS AND NUMBERING OF SECTIONS, FRAGMENTS OR LEVELS

(Use an existing drawing or make a sketch of the mosaic indicating the north and the walls of the room)

DIMENSIONS AND NUMBERING OF SECTIONS, FRAGMENTS OR LEVELS

(Use an existing drawing or make a sketch of the mosaic indicating the north and the walls of the room)

GENERAL OBSERVATIONS ON THE CONSTRUCTION TECHNIQUE

(Type of pavement, decoration, materials, colors, tesserae sizes, etc.)

PREPARED BY

DATE

DATA FORM NO. 1 – IDENTIFICATION

STUDY PHASE

MOSAIC ID _____ / _____ / _____ / _____

This form must be completed with the site manager. It should be supplemented by an overall photograph of the mosaic and a plan of the building indicating the location of the room.

SITE

BUILDING

ROOM

SECTIONS, FRAGMENTS OR LEVELS

(Use Arabic numerals for sections, letters for fragments, Roman numerals for levels)

MOSAIC ID

_____ / _____ / _____ / _____
(Abbreviation of the site / building / room / sections or fragments or levels)

EXISTING DOCUMENTATION ABOUT THE MOSAIC AND ITS CONSERVATION

(References of publications, plans, photographs, drawings and other documents)

DATE OF MOSAIC EXCAVATION:

DIMENSIONS AND NUMBERING OF SECTIONS, FRAGMENTS OR LEVELS

(Use an existing drawing or make a sketch of the mosaic indicating the north and the walls of the room)

GENERAL OBSERVATIONS ON THE CONSTRUCTION TECHNIQUE

(Type of pavement, decoration, materials, colors, tesserae sizes, etc.)

GENERAL OBSERVATIONS ON THE CONSTRUCTION TECHNIQUE

(Type of pavement, decoration, materials, colors, tesserae sizes, etc.)

PREPARED BY

DATE

DATA FORM NO. 1 – IDENTIFICATION

STUDY PHASE

MOSAIC ID _____ / _____ / _____ / _____

This form must be completed with the site manager. It should be supplemented by an overall photograph of the mosaic and a plan of the building indicating the location of the room.

SITE

BUILDING

ROOM

SECTIONS, FRAGMENTS OR LEVELS

(Use Arabic numerals for sections, letters for fragments, Roman numerals for levels)

MOSAIC ID

_____ / _____ / _____ / _____
(Abbreviation of the site / building / room / sections or fragments or levels)

EXISTING DOCUMENTATION ABOUT THE MOSAIC AND ITS CONSERVATION

(References of publications, plans, photographs, drawings and other documents)

DATE OF MOSAIC EXCAVATION:

DIMENSIONS AND NUMBERING OF SECTIONS, FRAGMENTS OR LEVELS

(Use an existing drawing or make a sketch of the mosaic indicating the north and the walls of the room)

GENERAL OBSERVATIONS ON THE CONSTRUCTION TECHNIQUE

(Type of pavement, decoration, materials, colors, tesserae sizes, etc.)

PREPARED BY

DATE

PREPARED BY

DATE

CASE STUDY

Hergla, Tunisia

House “of the two peristyles”

ID: HE/H2P/25



Site: Hergla, Tunisia

House « of the two peristyles »

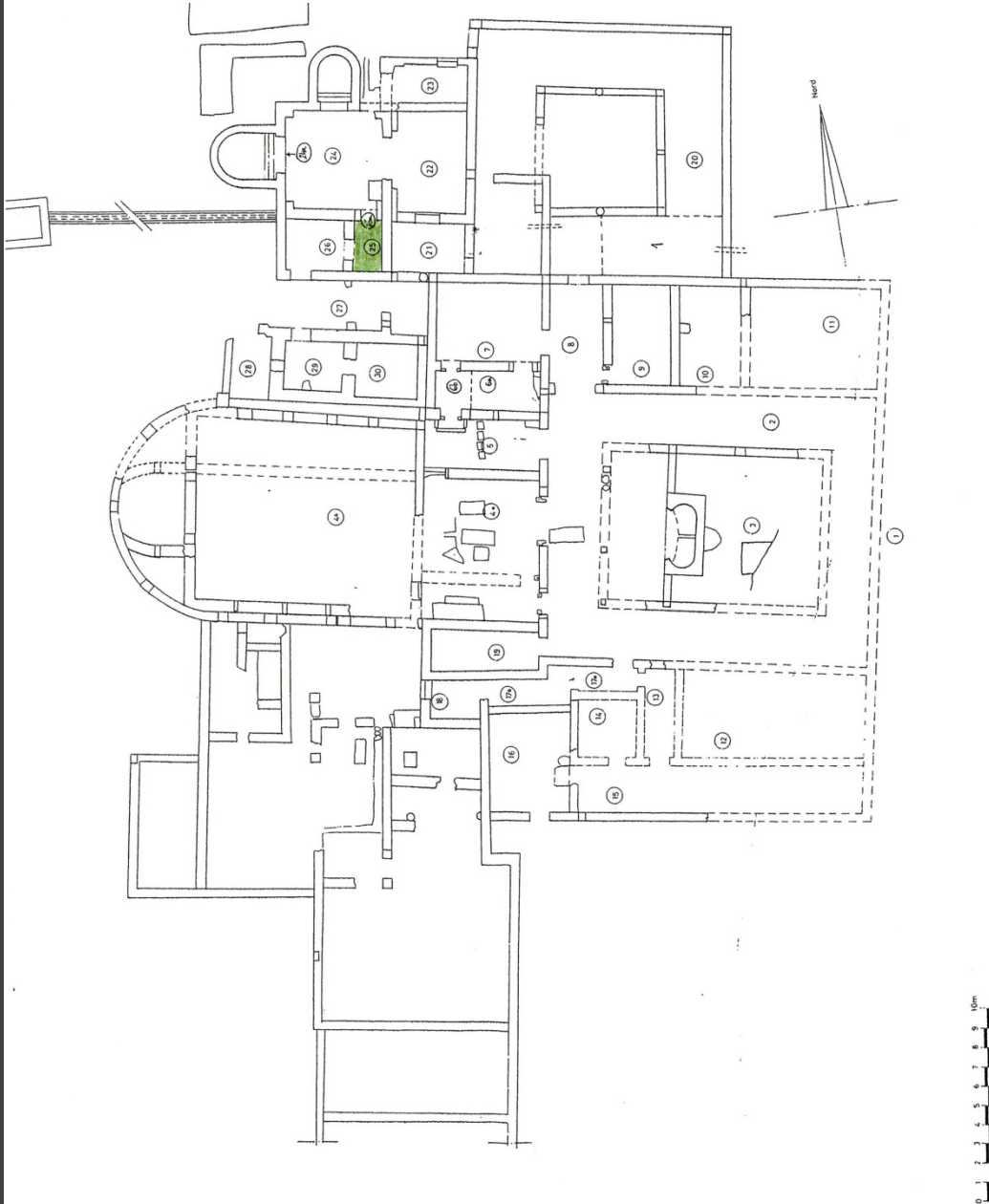

Livia Alberti 2005 © J. Paul Getty Trust



Sebastiaan Godis 2010 © J. Paul Getty Trust

DATA FORM NO. 1 – IDENTIFICATION

STUDY PHASE

MOSAIC ID _____ / _____ / _____ / _____

This form must be completed with the site manager. It should be supplemented by an overall photograph of the mosaic and a plan of the building indicating the location of the room.

SITE

BUILDING

ROOM

SECTIONS, FRAGMENTS OR LEVELS

(Use Arabic numerals for sections, letters for fragments, Roman numerals for levels)

MOSAIC ID

_____/_____/_____/_____
(Abbreviation of the site / building / room / sections or fragments or levels)

EXISTING DOCUMENTATION ABOUT THE MOSAIC AND ITS CONSERVATION

(References of publications, plans, photographs, drawings and other documents)

DATE OF MOSAIC EXCAVATION:

DIMENSIONS AND NUMBERING OF SECTIONS, FRAGMENTS OR LEVELS

(Use an existing drawing or make a sketch of the mosaic indicating the north and the walls of the room)

GENERAL OBSERVATIONS ON THE CONSTRUCTION TECHNIQUE

(Type of pavement, decoration, materials, colors, tesserae sizes, etc.)

PREPARED BY

DATE

MOSAIC ID HE / H2P / 25 / _____

This form must be completed with the site manager. It should be supplemented by an overall photograph of the mosaic and a plan of the building indicating the location of the room.

SITE *Hergla (HE)*

BUILDING *House "of the two peristyles" (H2P)*

ROOM *25*

SECTIONS, FRAGMENTS OR LEVELS

(Use Arabic numerals for sections, letters for fragments, Roman numerals for levels)

MOSAIC ID

HE / H2P / 25 / _____
(Abbreviation of the site / building / room / sections or fragments or levels)

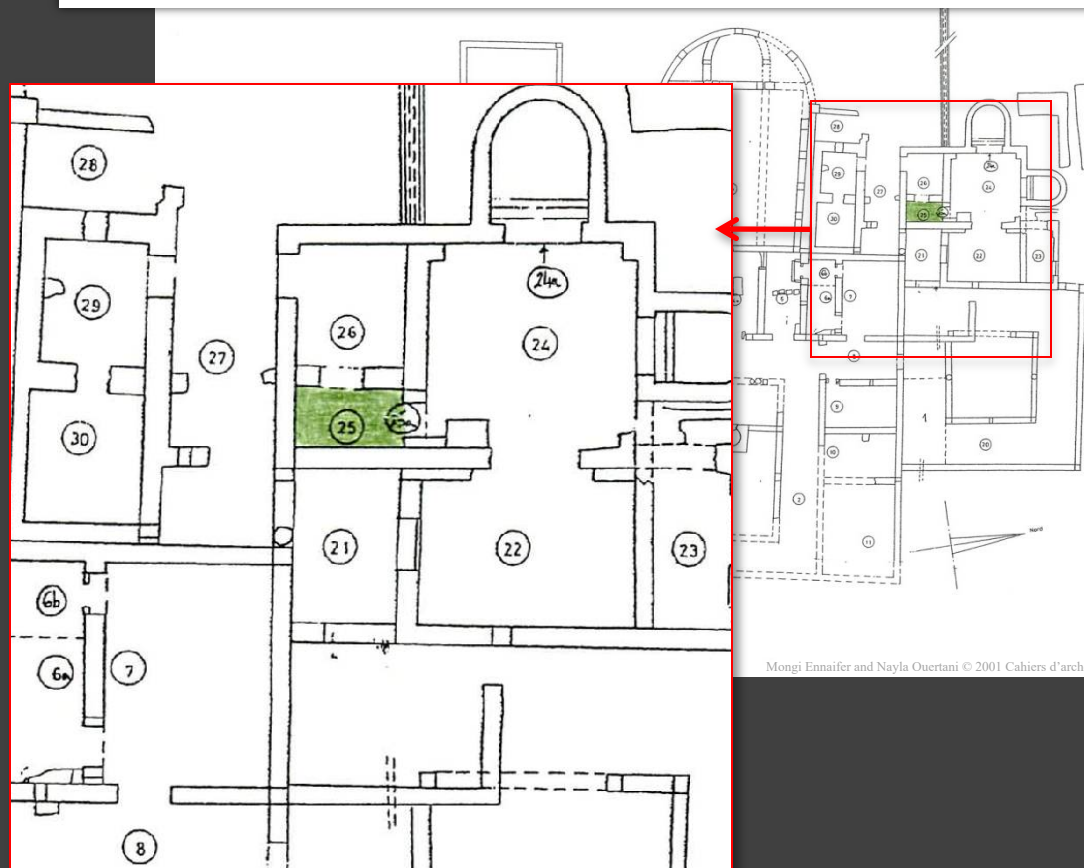

Site: Hergla, Tunisia
House « of the two peristyles »

Mongi Ennaifer and Nayla Ouertani © 2001 Cahiers d'archéologie romande

MOSAIC ID _____ / _____ / _____ / _____

This form must be completed with the site manager. It should be supplemented by an overall photograph of the mosaic and a plan of the building indicating the location of the room.

SITE

BUILDING

ROOM

SECTIONS, FRAGMENTS OR LEVELS

(Use Arabic numerals for sections, letters for fragments, Roman numerals for levels)

MOSAIC ID

_____ / _____ / _____ / _____
(Abbreviation of the site / building / room / sections or fragments or levels)

EXISTING DOCUMENTATION ABOUT THE MOSAIC AND ITS CONSERVATION

(References of publications, plans, photographs, drawings and other documents)

DATE OF MOSAIC EXCAVATION:

DIMENSIONS AND NUMBERING OF SECTIONS, FRAGMENTS OR LEVELS

(Use an existing drawing or make a sketch of the mosaic indicating the north and the walls of the room)

GENERAL OBSERVATIONS ON THE CONSTRUCTION TECHNIQUE

(Type of pavement, decoration, materials, colors, tesserae sizes, etc.)

How to number the divisions of a mosaic

SECTIONS, FRAGMENTS OR LEVELS 1, 2, 3, 4

(Use Arabic numerals for sections, letters for fragments, Roman numerals for levels)

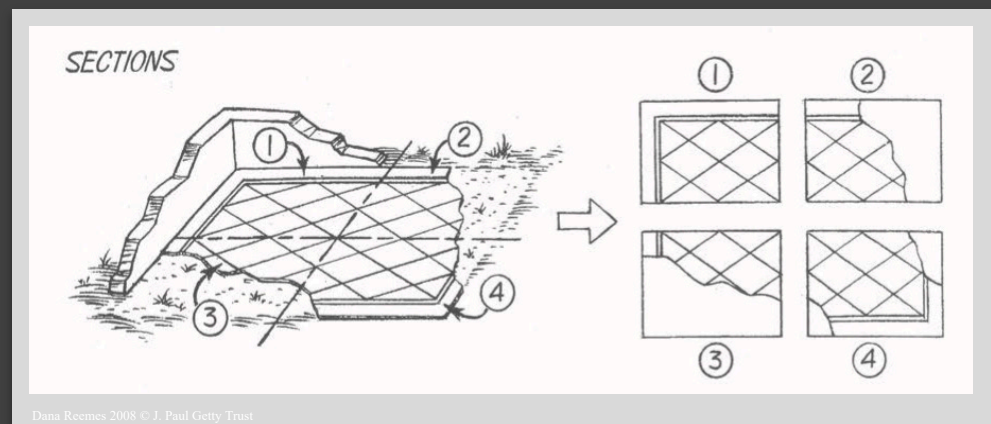

Dana Reemes 2008 © J. Paul Getty Trust

DATA FORM NO. 1 – IDENTIFICATION

STUDY PHASE

MOSAIC ID _____ / _____ / _____ / _____

This form must be completed with the site manager. It should be supplemented by an overall photograph of the mosaic and a plan of the building indicating the location of the room.

SITE

BUILDING

ROOM

SECTIONS, FRAGMENTS OR LEVELS

(Use Arabic numerals for sections, letters for fragments, Roman numerals for levels)

MOSAIC ID

_____ / _____ / _____ / _____
(Abbreviation of the site / building / room / sections or fragments or levels)

EXISTING DOCUMENTATION ABOUT THE MOSAIC AND ITS CONSERVATION

(References of publications, plans, photographs, drawings and other documents)

EXISTING DOCUMENTATION ABOUT THE MOSAIC AND ITS CONSERVATION

(References of publications, plans, photographs, drawings and other documents)

Map of building from INP archives in Tunis

DATE OF MOSAIC EXCAVATION:

DIMENSIONS AND NUMBERING OF SECTIONS, FRAGMENTS OR LEVELS

(Use an existing drawing or make a sketch of the mosaic indicating the north and the walls of the room)

GENERAL OBSERVATIONS ON THE CONSTRUCTION TECHNIQUE

(Type of pavement, decoration, materials, colors, tesserae sizes, etc.)

PREPARED BY

DATE

DATA FORM NO. 1 – IDENTIFICATION

STUDY PHASE

MOSAIC ID _____ / _____ / _____ / _____

This form must be completed with the site manager. It should be supplemented by an overall photograph of the mosaic and a plan of the building indicating the location of the room.

SITE

BUILDING

ROOM

SECTIONS, FRAGMENTS OR LEVELS

(Use Arabic numerals for sections, letters for fragments, Roman numerals for levels)

MOSAIC ID

_____ / _____ / _____ / _____
(Abbreviation of the site / building / room / sections or fragments or levels)

EXISTING DOCUMENTATION ABOUT THE MOSAIC AND ITS CONSERVATION

(References of publications, plans, photographs, drawings and other documents)

DATE OF MOSAIC EXCAVATION:

DATE OF MOSAIC EXCAVATION: *Excavated in 1969*

DIMENSIONS AND NUMBERING OF SECTIONS, FRAGMENTS OR LEVELS

(Use an existing drawing or make a sketch of the mosaic indicating the north and the walls of the room)

GENERAL OBSERVATIONS ON THE CONSTRUCTION TECHNIQUE

(Type of pavement, decoration, materials, colors, tesserae sizes, etc.)

PREPARED BY

DATE

DATA FORM NO. 1 – IDENTIFICATION

STUDY PHASE

MOSAIC ID _____ / _____ / _____ / _____

This form must be completed with the site manager. It should be supplemented by an overall photograph of the mosaic and a plan of the building indicating the location of the room.

SITE

BUILDING

ROOM

SECTIONS, FRAGMENTS OR LEVELS

(Use Arabic numerals for sections, letters for fragments, Roman numerals for levels)

MOSAIC ID

_____/_____/_____/_____
(Abbreviation of the site / building / room / sections or fragments or levels)

EXISTING DOCUMENTATION ABOUT THE MOSAIC AND ITS CONSERVATION

(References of publications, plans, photographs, drawings and other documents)

DATE OF MOSAIC EXCAVATION:

DIMENSIONS AND NUMBERING OF SECTIONS, FRAGMENTS OR LEVELS

(Use an existing drawing or make a sketch of the mosaic indicating the north and the walls of the room)

GENERAL OBSERVATIONS ON THE CONSTRUCTION TECHNIQUE

(Type of pavement, decoration, materials, colors, tesserae sizes, etc.)



Livia Alberti 2005 © J. Paul Getty Trust

DIMENSIONS AND NUMBERING OF SECTIONS, FRAGMENTS OR LEVELS

(Use an existing drawing or make a sketch of the mosaic indicating the north and the walls of the room)

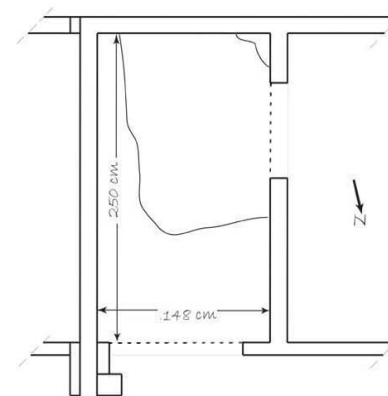

PREPARED BY

DATE

DATA FORM NO. 1 – IDENTIFICATION

STUDY PHASE

MOSAIC ID _____ / _____ / _____ / _____

This form must be completed with the site manager. It should be supplemented by an overall photograph of the mosaic and a plan of the building indicating the location of the room.

SITE

BUILDING

ROOM

SECTIONS, FRAGMENTS OR LEVELS

(Use Arabic numerals for sections, letters for fragments, Roman numerals for levels)

MOSAIC ID

_____/_____/_____/_____
(Abbreviation of the site / building / room / sections or fragments or levels)

EXISTING DOCUMENTATION ABOUT THE MOSAIC AND ITS CONSERVATION

(References of publications, plans, photographs, drawings and other documents)

DATE OF MOSAIC EXCAVATION:

DIMENSIONS AND NUMBERING OF SECTIONS, FRAGMENTS OR LEVELS

(Use an existing drawing or make a sketch of the mosaic indicating the north and the walls of the room)

GENERAL OBSERVATIONS ON THE CONSTRUCTION TECHNIQUE

(Type of pavement, decoration, materials, colors, tesserae sizes, etc.)

PREPARED BY

DATE

Dimensions and numbering of **SECTIONS** in the drawing

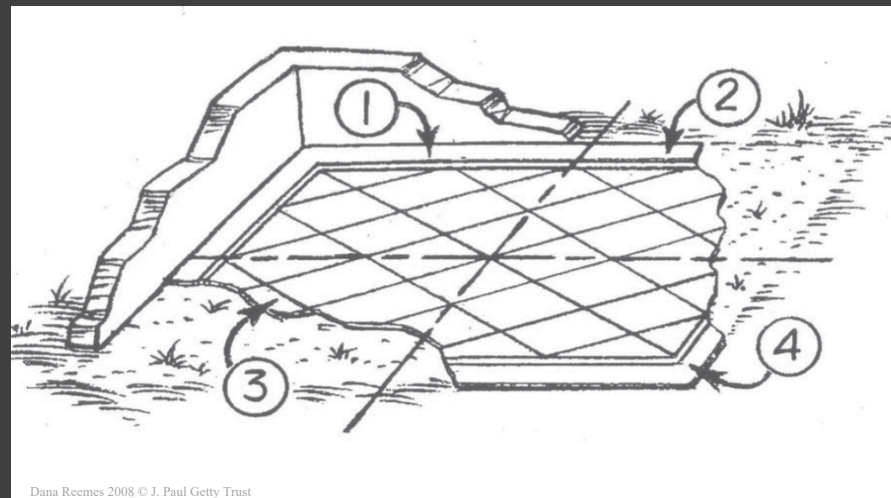

DIMENSIONS AND NUMBERING OF SECTIONS, FRAGMENTS OR LEVELS

(Use an existing drawing or make a sketch of the mosaic indicating the north and the walls of the room)

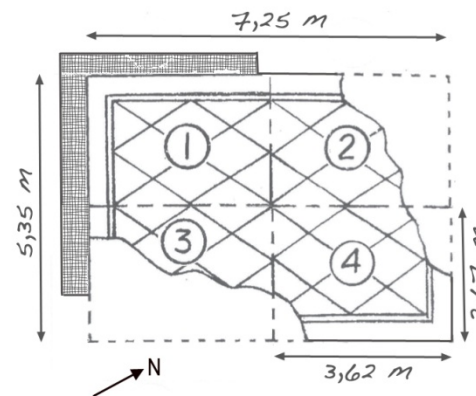

Dana Reemes 2008 © J. Paul Getty Trust

DATA FORM NO. 1 – IDENTIFICATION

STUDY PHASE

MOSAIC ID _____ / _____ / _____ / _____

This form must be completed with the site manager. It should be supplemented by an overall photograph of the mosaic and a plan of the building indicating the location of the room.

SITE

BUILDING

ROOM

SECTIONS, FRAGMENTS OR LEVELS

(Use Arabic numerals for sections, letters for fragments, Roman numerals for levels)

MOSAIC ID

_____/_____/_____/_____
(Abbreviation of the site / building / room / sections or fragments or levels)

EXISTING DOCUMENTATION ABOUT THE MOSAIC AND ITS CONSERVATION

(References of publications, plans, photographs, drawings and other documents)

DATE OF MOSAIC EXCAVATION:

DIMENSIONS AND NUMBERING OF SECTIONS, FRAGMENTS OR LEVELS

(Use an existing drawing or make a sketch of the mosaic indicating the north and the walls of the room)

GENERAL OBSERVATIONS ON THE CONSTRUCTION TECHNIQUE

(Type of pavement, decoration, materials, colors, tesserae sizes, etc.)

Dimensions and numbering of **FRAGMENTS** in the drawing

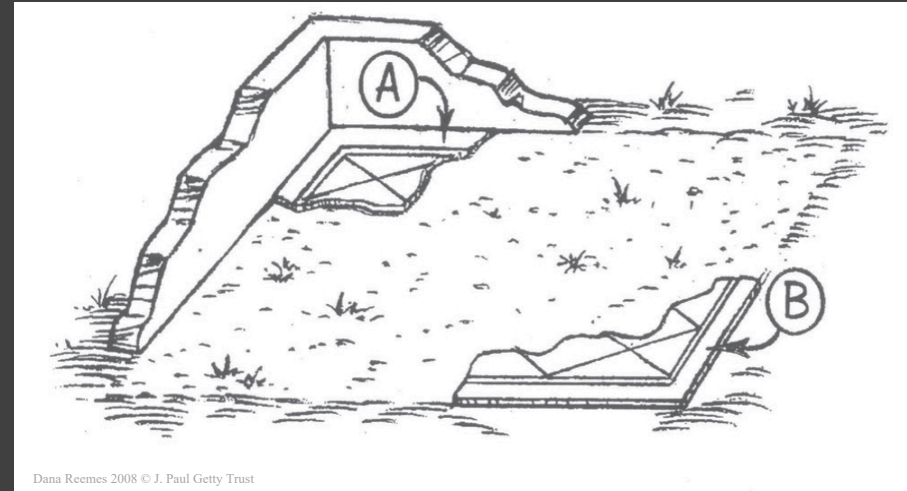

Dana Reemes 2008 © J. Paul Getty Trust

DIMENSIONS AND NUMBERING OF SECTIONS, FRAGMENTS OR LEVELS

(Use an existing drawing or make a sketch of the mosaic indicating the north and the walls of the room)

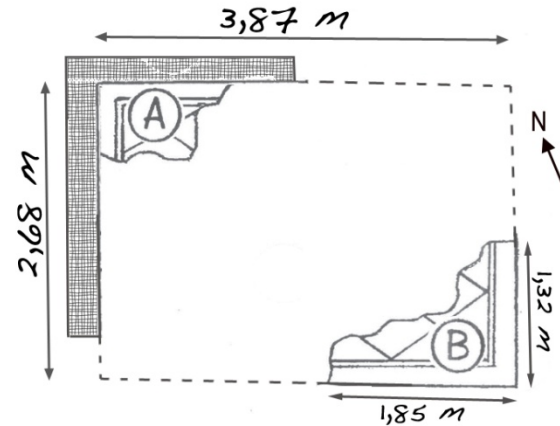

Dana Reemes 2008 © J. Paul Getty Trust

DATA FORM NO. 1 – IDENTIFICATION

STUDY PHASE

MOSAIC ID _____ / _____ / _____ / _____

This form must be completed with the site manager. It should be supplemented by an overall photograph of the mosaic and a plan of the building indicating the location of the room.

SITE

BUILDING

ROOM

SECTIONS, FRAGMENTS OR LEVELS

(Use Arabic numerals for sections, letters for fragments, Roman numerals for levels)

MOSAIC ID

_____/_____/_____/_____
(Abbreviation of the site / building / room / sections or fragments or levels)

EXISTING DOCUMENTATION ABOUT THE MOSAIC AND ITS CONSERVATION

(References of publications, plans, photographs, drawings and other documents)

DATE OF MOSAIC EXCAVATION:

DIMENSIONS AND NUMBERING OF SECTIONS, FRAGMENTS OR LEVELS

(Use an existing drawing or make a sketch of the mosaic indicating the north and the walls of the room)

GENERAL OBSERVATIONS ON THE CONSTRUCTION TECHNIQUE

(Type of pavement, decoration, materials, colors, tesserae sizes, etc.)

Dimensions and numbering of **LEVELS** in the drawing

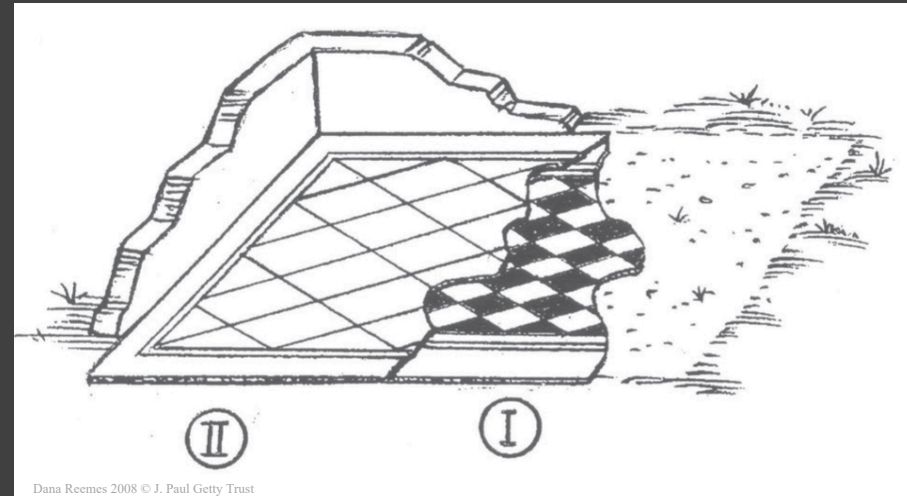

DIMENSIONS AND NUMBERING OF SECTIONS, FRAGMENTS OR LEVELS

(Use an existing drawing or make a sketch of the mosaic indicating the north and the walls of the room)

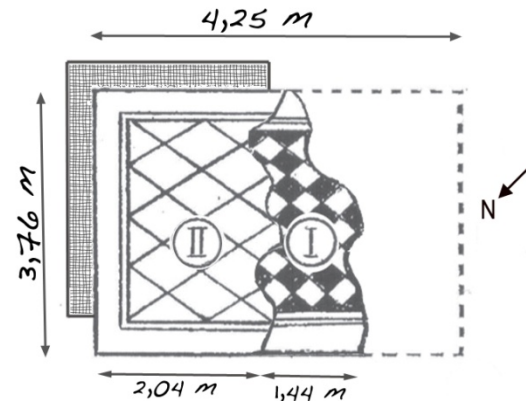

Dana Reemes 2008 © J. Paul Getty Trust

DATA FORM NO. 1 – IDENTIFICATION

STUDY PHASE

MOSAIC ID _____ / _____ / _____ / _____

This form must be completed with the site manager. It should be supplemented by an overall photograph of the mosaic and a plan of the building indicating the location of the room.

SITE

BUILDING

ROOM

SECTIONS, FRAGMENTS OR LEVELS

(Use Arabic numerals for sections, letters for fragments, Roman numerals for levels)

MOSAIC ID

_____/_____/_____/_____
(Abbreviation of the site / building / room / sections or fragments or levels)

EXISTING DOCUMENTATION ABOUT THE MOSAIC AND ITS CONSERVATION

(References of publications, plans, photographs, drawings and other documents)

DATE OF MOSAIC EXCAVATION:

DIMENSIONS AND NUMBERING OF SECTIONS, FRAGMENTS OR LEVELS

(Use an existing drawing or make a sketch of the mosaic indicating the north and the walls of the room)



Amel Chabbi 2005 © J. Paul Getty Trust



Amel Chabbi 2005 © J. Paul Getty Trust



Livia Alberti 2005 © J. Paul Getty Trust

GENERAL OBSERVATIONS ON THE CONSTRUCTION TECHNIQUE

(Type of pavement, decoration, materials, colors, tesserae sizes, etc.)

GENERAL OBSERVATIONS ON THE CONSTRUCTION TECHNIQUE

(Type of pavement, decoration, materials, colors, tesserae sizes, etc.)

Pavement in Opus Tessellatum, polychrome geometric tesserae in white, black, green, yellow, pink, and red limestone. Dimensions of the tesserae: 0.80cm x 1.00cm; 1.00cm x 1.00cm; 1.20cm x 1.00cm

PREPARED BY

DATE

DATA FORM NO. 1 – IDENTIFICATION

STUDY PHASE

MOSAIC ID _____ / _____ / _____ / _____

This form must be completed with the site manager. It should be supplemented by an overall photograph of the mosaic and a plan of the building indicating the location of the room.

SITE

BUILDING

ROOM

SECTIONS, FRAGMENTS OR LEVELS

(Use Arabic numerals for sections, letters for fragments, Roman numerals for levels)

MOSAIC ID

_____ / _____ / _____ / _____
(Abbreviation of the site / building / room / sections or fragments or levels)

EXISTING DOCUMENTATION ABOUT THE MOSAIC AND ITS CONSERVATION

(References of publications, plans, photographs, drawings and other documents)

DATE OF MOSAIC EXCAVATION:

DIMENSIONS AND NUMBERING OF SECTIONS, FRAGMENTS OR LEVELS

(Use an existing drawing or make a sketch of the mosaic indicating the north and the walls of the room)

GENERAL OBSERVATIONS ON THE CONSTRUCTION TECHNIQUE

(Type of pavement, decoration, materials, colors, tesserae sizes, etc.)

PREPARED BY

Mohamed Said

DATE

June 2005

PREPARED BY

DATE

DATA FORM NO. 1 – IDENTIFICATION

STUDY PHASE

MOSAIC ID HE / H2P / 25 / _____

This form must be completed with the site manager. It should be supplemented by an overall photograph of the mosaic and a plan of the building indicating the location of the room.

SITE Hergla (HE)

BUILDING House "of the two peristyles" (H2P)

ROOM 25

SECTIONS, FRAGMENTS OR LEVELS

(Use Arabic numerals for sections, letters for fragments, Roman numerals for levels)

MOSAIC ID HE / H2P / 25 / _____

(Abbreviation of the site / building / room / sections or fragments or levels)

EXISTING DOCUMENTATION ABOUT THE MOSAIC AND ITS CONSERVATION

(References of publications, plans, photographs, drawings and other documents)

Map of building from INP archives in Tunis

DATE OF MOSAIC EXCAVATION: Excavated in 1969

DIMENSIONS AND NUMBERING OF SECTIONS, FRAGMENTS OR LEVELS

(Use an existing drawing or make a sketch of the mosaic indicating the north and the walls of the room)

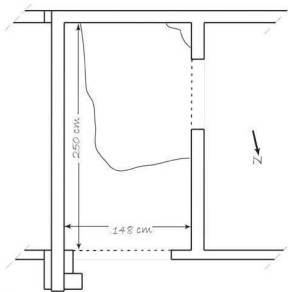

GENERAL OBSERVATIONS ON THE CONSTRUCTION TECHNIQUE

(Type of pavement, decoration, materials, colors, tesserae sizes, etc.)

*Pavement in Opus Tessellatum, polychrome geometric tesserae in white, black, green, yellow, pink, and red limestone.
Dimensions of the tesserae: 0.80cm x 1.00cm; 1.00cm x 1.00cm;
1.20cm x 1.00cm*

PREPARED BY

Mohamed Said

DATE

June 2005

Site: Hergla, Tunisia
House « of the two peristyles »

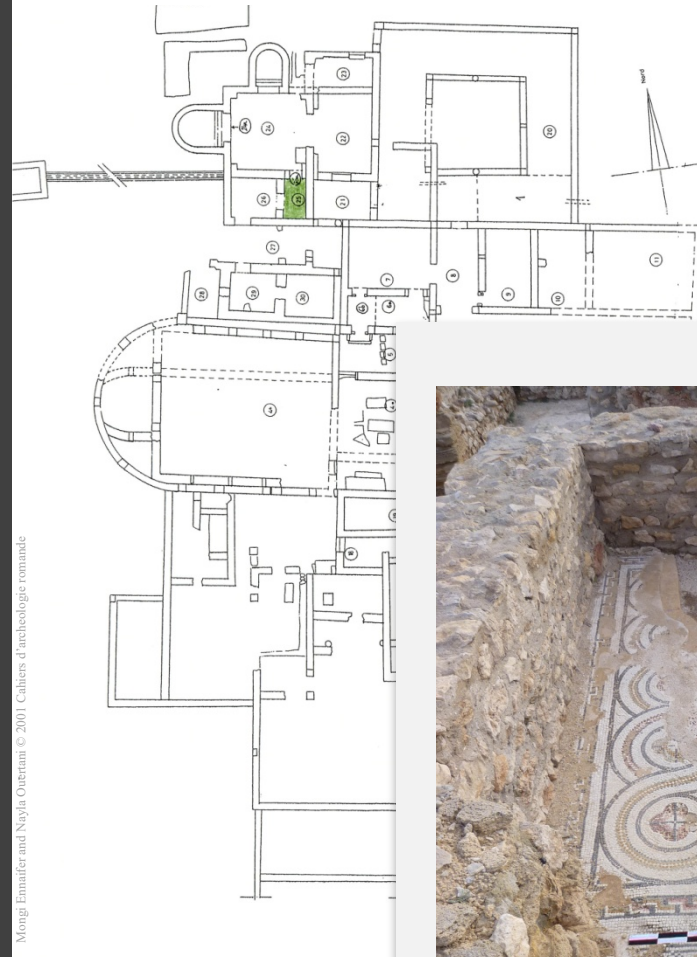

Monggi Einauer and Nayla Oubtrant © 2001 Cahiers d'archéologie romande



Livia Alberti 2005 © J. Paul Getty Trust

HE-H2P-25_2005-06-17_ID_GeneralPhoto

Getty



MOSAIKON is a partnership of four institutions: the Getty Conservation Institute, the Getty Foundation, ICCROM, and ICCM. The aims of the project are to strengthen the network of professionals concerned with the conservation, restoration, maintenance, and management of mosaic heritage in the southern and eastern Mediterranean region; provide training to a variety of individuals involved in mosaics conservation and, more generally, with the management of archaeological sites and museums with mosaics; work with national and international bodies to provide a more favorable legislative, regulatory, and economic environment for the conservation of mosaics in the Mediterranean; and promote the dissemination and exchange of information.

