

Getty



TECHNICIAN TRAINING FOR THE CONSERVATION OF MOSAICS

PART 1
THE CONSERVATION OF IN SITU MOSAICS

Archiving documentation



Livia Alberti, Ermanno Carbonara, Thomas Roby



All the documentation elements created during the mosaic maintenance process, whether in **paper form** or **digital form**, should be properly organized and conserved so that they can be readily accessed and used in the future.

These documentation elements all together form the mosaic conservation archive of a site.

Archiving of paper documentation

Archiving Data Form

This form lists the documentation elements contained in the folder pertaining to a mosaic.

ARCHIVING DATA FORM

SITE NAME _____

MOSAIC ID _____ / _____ / _____ / _____

	INITIAL CAMPAIGN	DATES OF COMPLETION (month and year)					
		MAINTENANCE CYCLES					
Base drawing/photograph							
Data Form No.1 – Identification							
Building plan and overall photograph							
Data Form No. 2 – Previous Interventions							
Map and Legend – Previous Interventions							
Data Form No. 3 – Condition Assessment							
Map and Legend – Condition Assessment Map No. 1							
Map and Legend – Condition Assessment Map No. 2							
Map and Legend – Condition Assessment Map No. 3							
Map and Legend – Condition Assessment Map No. 4							
Data Form No. 4 – Intervention Planning							
Data Form No. 5 – Current Interventions							
Map and Legend – Current Interventions							
Printed photographs							
Photograph Maps							
Revised base drawing/photograph							

List of documents

	DATES OF COMPLETION (month and year)							
	INITIAL CAMPAIGN	MAINTENANCE CYCLES						
Base drawing/photograph								
Data Form No.1 – Identification								
Building plan and overall photograph								
Data Form No. 2 – Previous Interventions								
Map and Legend – Previous Interventions								
Data Form No. 3 – Condition Assessment								
Map and Legend – Condition Assessment Map No. 1								
Map and Legend – Condition Assessment Map No. 2								
Map and Legend – Condition Assessment Map No. 3								
Map and Legend – Condition Assessment Map No. 4								
Data Form No. 4 – Intervention Planning								
Data Form No. 5 – Current Interventions								
Map and Legend – Current Interventions								
Printed photographs								
Photograph Maps								
Revised base drawing/photograph								

ARCHIVING DATA FORM

SITE NAME _____

MOSAIC ID _____ / _____ / _____

Date of each document created during the initial campaign

	DATES OF COMPLETION (month and year)							
	INITIAL CAMPAIGN	MAINTENANCE CYCLES						
Base drawing/photograph								
Data Form No.1 – Identification								
Building plan and overall photograph								
Data Form No. 2 – Previous Interventions								
Map and Legend – Previous Interventions								
Data Form No. 3 – Condition Assessment								
Map and Legend – Condition Assessment Map No. 1								
Map and Legend – Condition Assessment Map No. 2								
Map and Legend – Condition Assessment Map No. 3								
Map and Legend – Condition Assessment Map No. 4								
Data Form No. 4 – Intervention Planning								
Data Form No. 5 – Current Interventions								
Map and Legend – Current Interventions								
Printed photographs								
Photograph Maps								
Revised base drawing/photograph								

ARCHIVING DATA FORM

SITE NAME _____

MOSAIC ID _____ / _____ / _____

Dates of new documents created during each maintenance cycle

	DATES OF COMPLETION (month and year)							
	INITIAL CAMPAIGN	MAINTENANCE CYCLES						
Base drawing/photograph								
Data Form No.1 – Identification								
Building plan and overall photograph								
Data Form No. 2 – Previous Interventions								
Map and Legend – Previous Interventions								
Data Form No. 3 – Condition Assessment								
Map and Legend – Condition Assessment Map No. 1								
Map and Legend – Condition Assessment Map No. 2								
Map and Legend – Condition Assessment Map No. 3								
Map and Legend – Condition Assessment Map No. 4								
Data Form No. 4 – Intervention Planning								
Data Form No. 5 – Current Interventions								
Map and Legend – Current Interventions								
Printed photographs								
Photograph Maps								
Revised base drawing/photograph								

ARCHIVING DATA FORM

MOSAIC ID _____ / _____ / _____ / _____

SITE NAME _____

CASE STUDY

Hergla, Tunisia

House « of the two peristyles »
ID: HE/H2P/25

Complete example
of paper documentation



	DATES OF COMPLETION (month and year)				
	INITIAL CAMPAIGN	MAINTENANCE CYCLES			
Base drawing/ photograph	June 2005				
Data Form No.1 – Identification					
Building plan and overall photograph					
Data Form No. 2 – Previous Interventions					
Map and Legend – Previous Interventions					
Data Form No. 3 – Condition Assessment					
Map and Legend – Condition Assessment Map No. 1					
Map and Legend – Condition Assessment Map No. 2					
Map and Legend – Condition Assessment Map No. 3					
Map and Legend – Condition Assessment Map No. 4					
Data Form No. 4 – Intervention Planning					
Data Form No. 5 – Current Interventions					
Map and Legend – Current Interventions					
Printed photographs					
Photograph Maps					
Revised base drawing/photograph					

ARCHIVII

Elsa Bouguignon 2005 © J. Paul Getty Trust

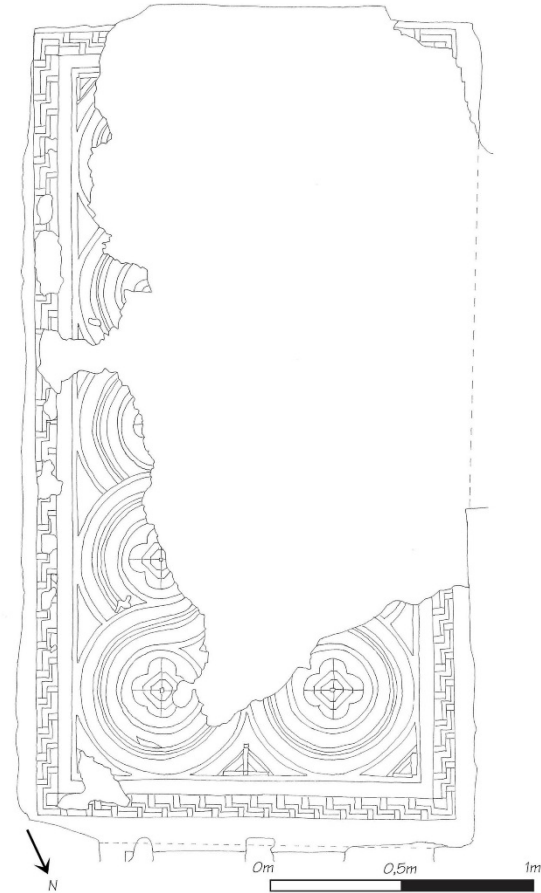

ID: HE/H2P/25

BASE MADE ON: June 2005

TITLE:

DATE:

PREPARED BY:

	DATES OF COMPLETION (month and year)			
	INITIAL CAMPAIGN			
Base drawing/photograph	June 2005			
Data Form No.1 – Identification	June 2005			
Building plan and overall photograph				
Data Form No. 2 – Previous Interventions				
Map and Legend – Previous Interventions				
Data Form No. 3 – Condition Assessment				
Map and Legend – Condition Assessment Map No. 1				
Map and Legend – Condition Assessment Map No. 2				
Map and Legend – Condition Assessment Map No. 3				
Map and Legend – Condition Assessment Map No. 4				
Data Form No. 4 – Intervention Planning				
Data Form No. 5 – Current Interventions				
Map and Legend – Current Interventions				
Printed photographs				
Photograph Maps				
Revised base drawing/photograph				

DATA FORM NO. 1 – IDENTIFICATION

STUDY PHASE

MOSAIC ID *HE* / *H2P* / *25* /

This form must be completed with the site manager. It should be supplemented by an overall photograph of the mosaic and a plan of the building indicating the location of the room.

SITE *Hergla (HE)*

BUILDING *House "of the two peristyles" (H2P)*

ROOM *25*

SECTIONS, FRAGMENTS OR LEVELS

(Use Arabic numerals for sections, letters for fragments, Roman numerals for levels)

MOSAIC ID *HE* / *H2P* / *25* /
(Abbreviation of the site / building / room / sections or fragments or levels)

EXISTING DOCUMENTATION ABOUT THE MOSAIC AND ITS CONSERVATION

(References of publications, plans, photographs, drawings and other documents)

Map of building from INP archives in Tunis

DATE OF MOSAIC EXCAVATION: *Excavated in 1969*

DIMENSIONS AND NUMBERING OF SECTIONS, FRAGMENTS OR LEVELS

(Use an existing drawing or make a sketch of the mosaic indicating the north and the walls of the room)

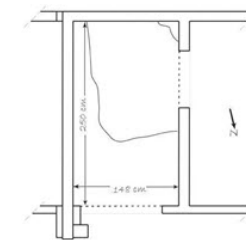

GENERAL OBSERVATIONS ON THE CONSTRUCTION TECHNIQUE

(Type of pavement, decoration, materials, colors, tesserae sizes, etc.)

Pavement in Opus Tessellatum, polychrome geometric tesserae in white, black, green, yellow, pink, and red limestone. Dimensions of the tesserae: 0.80cm x 1.00cm; 1.00cm x 1.00cm; 1.20cm x 1.00cm

PREPARED BY *Mohamed Said*

DATE *June 2005*

	DATES OF COMPLETION (month and year)			
	INITIAL CAMPAIGN	MAINTENANCE CYCLES		
Base drawing/photograph	June 2005			
Data Form No.1 – Identification	June 2005			
Building plan and overall photograph	June 2005			
Data Form No. 2 – Previous Interventions				
Map and Legend – Previous Interventions				
Data Form No. 3 – Condition Assessment				
Map and Legend – Condition Assessment Map No. 1				
Map and Legend – Condition Assessment Map No. 2				
Map and Legend – Condition Assessment Map No. 3				
Map and Legend – Condition Assessment Map No. 4				
Data Form No. 4 – Intervention Planning				
Data Form No. 5 – Current Interventions				
Map and Legend – Current Interventions				
Printed photographs				
Photograph Maps				
Revised base drawing/photograph				

ARCHIVING DATA FORM



HE-H2P-25_2005-06-17_ID_GeneralPhoto

	DATES OF COMPLETION (month and year)			
	INITIAL CAMPAIGN			MA
Base drawing/ photograph	June 2005			
Data Form No.1 – Identification	June 2005			
Building plan and overall photograph	June 2005			
Data Form No. 2 – Previous Interventions	June 2005			
Map and Legend – Previous Interventions				
Data Form No. 3 – Condition Assessment				
Map and Legend – Condition Assessment Map No. 1				
Map and Legend – Condition Assessment Map No. 2				
Map and Legend – Condition Assessment Map No. 3				
Map and Legend – Condition Assessment Map No. 4				
Data Form No. 4 – Intervention Planning				
Data Form No. 5 – Current Interventions				
Map and Legend – Current Interventions				
Printed photographs				
Photograph Maps				
Revised base drawing/photograph				

DATA FORM NO. 2 – PREVIOUS INTERVENTIONS

STUDY PHASE

MOSAIC ID HE/ H2P/ 25/

PREVIOUS INTERVENTIONS ON THE MOSAIC

Mortar repairs

- Infilling of lacunae
- Edging repair
- Filling of interstices between tesserae
- Grouting of voids between preparatory layers

Reintegration of lacunae

- with tesserae
- with pieces of stone, brick or other material inserted into the mortar

Lifting and relaying on a new support

- Reinforced concrete/cement support
- Other type of support: _____

Surface treatment

- Chemical cleaning
- Mechanical abrasion
- Application of a surface product (resin, wax, etc.)
- Other: _____

 Parts detached and stored elsewhere Reburial (Draw a vertical section of the reburial; describe the fill materials and separation membranes used, provide the total thickness and the thickness of each layer)

PREVIOUS INTERVENTIONS AROUND THE MOSAIC

- Drainage
- Removable cover
- Access barrier: _____
- Open shelter
- Closed shelter
- Wall stabilization
- Other: _____

DATES OF PREVIOUS INTERVENTIONS CARRIED OUT AND INFORMATION SOURCES

First: on discovery of the pavement by archaeologists in 1969.

Second: in the 1980s

Source: Mr. Hamza, site guard

PREPARED BY

Mohamed Said

DATE

June 2005

	DATES OF COMPLETION (month and year)			
	INITIAL CAMPAIGN			
Base drawing/photograph	June 2005			
Data Form No.1 – Identification	June 2005			
Building plan and overall photograph	June 2005			
Data Form No. 2 – Previous Interventions	June 2005			
Map and Legend – Previous Interventions	June 2005			
Data Form No. 3 – Condition Assessment				
Map and Legend – Condition Assessment Map No. 1				
Map and Legend – Condition Assessment Map No. 2				
Map and Legend – Condition Assessment Map No. 3				
Map and Legend – Condition Assessment Map No. 4				
Data Form No. 4 – Intervention Planning				
Data Form No. 5 – Current Interventions				
Map and Legend – Current Interventions				
Printed photographs				
Photograph Maps				
Revised base drawing/photograph				

Livia Alberti, Elsa Bourgaignon, Thomas Roby 2008, 2011, 2013 © J. Paul Getty Trust and Institut National du Patrimoine de Tunisie

LEGEND – PREVIOUS INTERVENTIONS MAP

MOSAIC ID HE H2P 25,

Mortar repairs

- Infilling of lacunae
- Edging repair
- Outline
- Overlap
- Filling of

Reintegration of lacunae

- Reinteg
- Reinteg

Detached mosaics

- Outline
- Location
- Parts de

Other types of interventions

- Reburial
- Drainage
-
-

PREPARED BY **Mohamed Said**

Elsa Bourgaignon 2005, Ermanno Carbonara 2013 © J. Paul Getty Trust



ID: HE/H2P/25

TITLE: Previous Interventions Map

DATE: June 2005

BASE MADE ON: June 2005

PREPARED BY: Mohamed Said

	DATES OF COMPLETION			
	INITIAL CAMPAIGN			
Base drawing/ photograph	June 2005			
Data Form No.1 – Identification	June 2005			
Building plan and overall photograph	June 2005			
Data Form No. 2 – Previous Interventions	June 2005			
Map and Legend – Previous Interventions	June 2005			
Data Form No. 3 – Condition Assessment	June 2005			
Map and Legend – Condition Assessment Map No. 1				
Map and Legend – Condition Assessment Map No. 2				
Map and Legend – Condition Assessment Map No. 3				
Map and Legend – Condition Assessment Map No. 4				
Data Form No. 4 – Intervention Planning				
Data Form No. 5 – Current Interventions				
Map and Legend – Current Interventions				
Printed photographs				
Photograph Maps				
Revised base drawing/photograph				

Livia Alberti, Elsa Bourgaignon, Thomas Roby 2008, 2011, 2013 © J. Paul Getty Trust and Institut National du Patrimoine de Tunisie

DATA FORM NO. 3 – CONDITION ASSESSMENT

STUDY PHASE

MOSAIC ID HE H2P / 25 / _____

INSPECTION TYPE Initial inspection Maintenance cycle

PRESENT EXPOSURE CONDITIONS

- In open air Reburied
- Walked on Under a removable cover
- Parts not excavated or inaccessible Under an open shelter
- Under a closed shelter

During the initial inspection, check the boxes of all the deterioration phenomena that are present. During maintenance cycles, only indicate new deterioration phenomena that have occurred since the last inspection or last intervention.

STRUCTURAL DETERIORATION

(Condition Assessment Map No. 1)

- Tessellatum lacunae Depressions
- Cracks Detachments between mosaic layers
- Bulges

SURFACE DETERIORATION

(Condition Assessment Map No. 2)

- Detached tesserae Stains
- Deteriorated tesserae Incrustations
- Deteriorated mortar between tesserae Efflorescence

PRESENCE OF BIO-DETERIORATION AGENTS

(Condition Assessment Map No. 3)

- Micro-organisms Tunnels or entrance holes made by insects and other animals
- Vegetation

DETERIORATION OF INTERVENTIONS

(Condition Assessment Map No. 4)

- Deteriorated lacunae fills or edging repairs Re-detached tesserae
- Deteriorated mortar between tesserae Deteriorated support panels
- Reburial:** Presence of vegetation Deteriorated support metal reinforcements
- Loss of fill materials
- Deteriorated separation membranes

DETERIORATION OF INTERVENTIONS AROUND THE MOSAIC

- Clogged drainage Deteriorated cover or shelter
- Stabilized walls with new deterioration Damaged access barrier
- Other: _____

OBSERVATIONS ON THE CONDITION ASSESSMENT

*Micro-organisms are concentrated in areas of the mosaic where there is more shade.
Areas of detachment are located near the surrounding walls.*

GENERAL CONDITION OF THE MOSAIC

- Good Fair Bad
- Date recommended for next inspection: _____
(No intervention required)
- Date recommended for intervention: Within 6 months
(Intervention required)

PREPARED BY Mohamed Said DATE June 2005

	DATES OF COMPLETION (month and year)				
	INITIAL CAMPAIGN	MAINTENANCE CYCLES			
Base drawing/photograph	June 2005				
Data Form No.1 – Identification	June 2005				
Building plan and overall photograph	June 2005				
Data Form No. 2 – Previous Interventions	June 2005				
Map and Legend – Previous Interventions	June 2005				
Data Form No. 3 – Condition Assessment	June 2005				
Map and Legend – Condition Assessment Map No. 1	June 2005				
Map and Legend – Condition Assessment Map No. 2	June 2005				
Map and Legend – Condition Assessment Map No. 3	June 2005				
Map and Legend – Condition Assessment Map No. 4	June 2005				
Data Form No. 4 – Intervention Planning					
Data Form No. 5 – Current Interventions					
Map and Legend – Current Interventions					
Printed photographs					
Photograph Maps					
Revised base drawing/photograph					

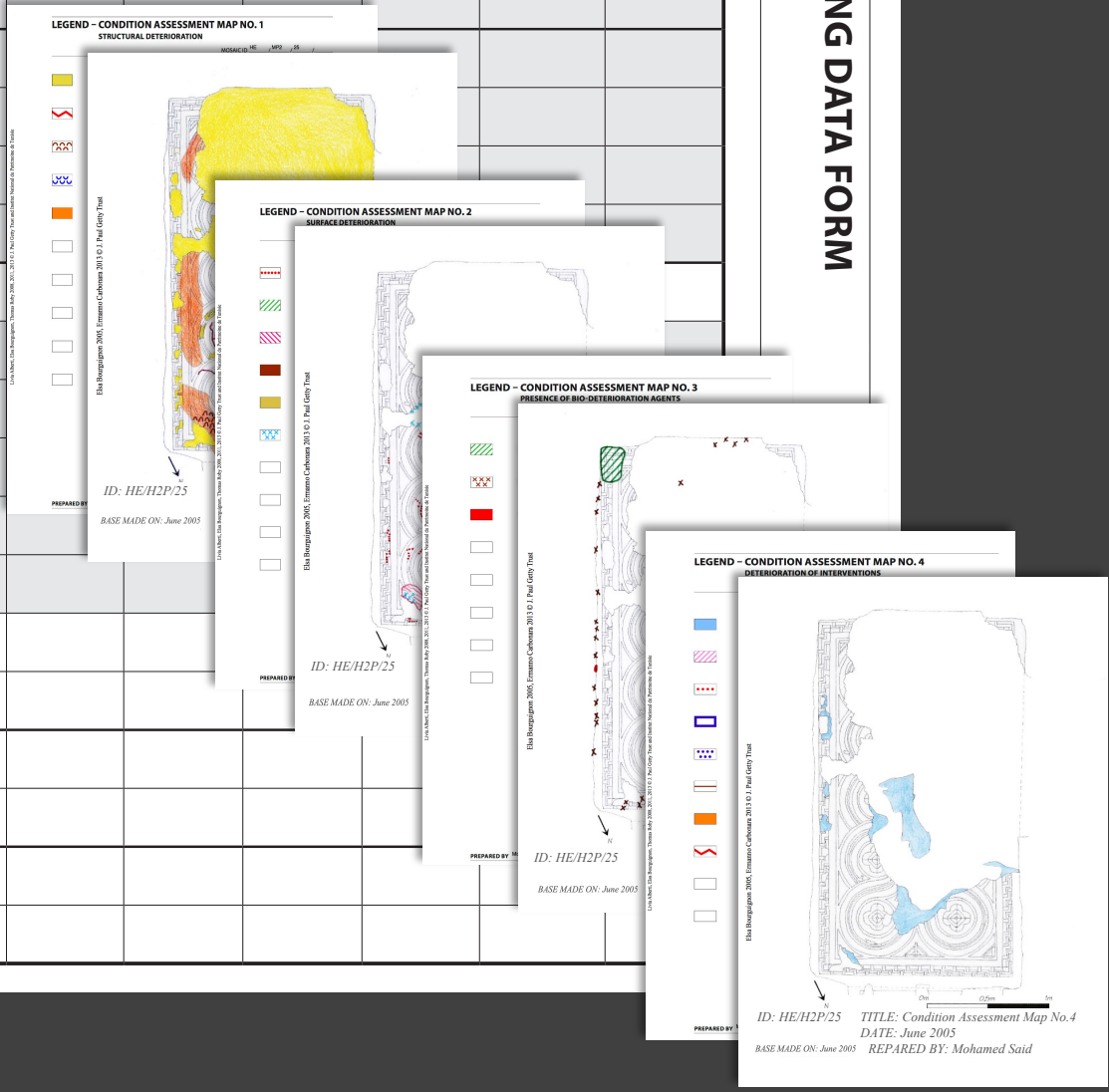

ARCHIVING DATA FORM

	DATES OF COMPLETION (month and year)			
	INITIAL CAMPAIGN			MAI
Base drawing/ photograph	June 2005			
Data Form No.1 – Identification	June 2005			
Building plan and overall photograph	June 2005			
Data Form No. 2 – Previous Interventions	June 2005			
Map and Legend – Previous Interventions	June 2005			
Data Form No. 3 – Condition Assessment	June 2005			
Map and Legend – Condition Assessment Map No. 1	June 2005			
Map and Legend – Condition Assessment Map No. 2	June 2005			
Map and Legend – Condition Assessment Map No. 3	June 2005			
Map and Legend – Condition Assessment Map No. 4	June 2005			
Data Form No. 4 – Intervention Planning	June 2005			
Data Form No. 5 – Current Interventions				
Map and Legend – Current Interventions				
Printed photographs				
Photograph Maps				
Revised base drawing/photograph				

Livia Alberti, Elsa Bourgaignon, Thomas Roby 2008, 2011, 2013 © J. Paul Getty Trust and Institut National du Patrimoine de Tunisie

DATA FORM NO.4 - INTERVENTION PLANNING

PLANNING PHASE

MOSAIC ID HE / H2P / 25 /

This form must be completed with the site manager.

TIME REQUIRED FOR ORGANIZATION AND COMPLETION OF THE WORK

- Vegetation removal 1 work days for 1 technician
Notes:
- Cleaning 1 work days for 1 technician
Notes: *without water over entire surface*
- Removal of modern repair mortars 2 work days for 1 technician
Notes:
- Resetting tesserae 3 work days for 1 technician
Notes:
- Filling interstices between tesserae 3 work days for 1 technician
Notes:
- Grouting voids between preparatory layers 2 work days for 1 technician
Notes:
- Infilling lacunae and edging repairs 4 work days for 1 technician
Notes: *infilling of small lacunae and edging repairs*
- Removal and resetting tesserae with facing ___ work days for 1 technician
Notes:
- Removal or treatment of support metal reinforcements ___ work days for 1 technician
Notes:
- Drainage ___ work days for 1 technician
Notes:
- Reburial ___ work days for 1 technician
Notes:
- Documentation 1 work days for 1 technician
Notes:
- Material preparation 1 work days for 1 technician
Notes:
- Other ___ work days for 1 technician
Notes:

TOTAL WORK DAYS FOR 1 TECHNICIAN: 18

Number of days / weeks / months: 10 days for number of technicians: 2

- Intervention by a specialist needed on or around the mosaic
Notes:

PREPARED BY Mohamed Said

DATE June 2005

	DATES OF COMPLETION (month and year)			
	INITIAL CAMPAIGN			MA
Base drawing/ photograph	June 2005			
Data Form No.1 – Identification	June 2005			
Building plan and overall photograph	June 2005			
Data Form No. 2 – Previous Interventions	June 2005			
Map and Legend – Previous Interventions	June 2005			
Data Form No. 3 – Condition Assessment	June 2005			
Map and Legend – Condition Assessment Map No. 1	June 2005			
Map and Legend – Condition Assessment Map No. 2	June 2005			
Map and Legend – Condition Assessment Map No. 3	June 2005			
Map and Legend – Condition Assessment Map No. 4	June 2005			
Data Form No. 4 – Intervention Planning	June 2005			
Data Form No. 5 – Current Interventions	October 2005			
Map and Legend – Current Interventions				
Printed photographs				
Photograph Maps				
Revised base drawing/photograph				

Livia Alberti, Elsa Bourgaignon, Thomas Roby 2008, 2011, 2013 © J. Paul Getty Trust and Institut National du Patrimoine de Tunisie

DATA FORM NO. 5 - CURRENT INTERVENTIONS
 MOSAIC ID HE / H2P 25 / / / /
 INTERVENTION PHASE

INTERVENTION TYPE Initial intervention Maintenance cycle

DATE OF PREVIOUS INTERVENTION *During the 1980s*

DATE OF PREVIOUS INSPECTION *June 2005*

DATE AND LENGTH OF CURRENT WORK *October 2005 - 10 days*

DATE RECOMMENDED FOR THE NEXT INSPECTION *July 2006*

TREATMENTS CARRIED OUT ON THE MOSAIC

- Vegetation removal
- Cleaning of the entire surface
- Cleaning of part of the surface
- Removal of modern repair mortars
- Resetting tesserae
- Filling interstices between tesserae
- Grouting voids between preparatory layers
- Infilling lacunae and/or edging repairs
- Removal and resetting tesserae with facing
- Removal of metal reinforcements in support panels
- Treatment of metal reinforcements in support panels
- Drainage
- Reburial (Draw a vertical section of the reburial: describe the fill materials and separation membranes used, provide the total thickness and the thickness of each layer)

INTERVENTIONS CARRIED OUT AROUND THE MOSAIC

- Wall stabilization
Notes:
- Other: _____
Notes:

NAMES OF THE TECHNICIANS WHO CARRIED OUT THE WORK *Mohamed Said and Nouredine Jaziri*

PREPARED BY *Mohamed Said* DATE *October 2005*

	DATES OF COMPLETION (month and year)						
	INITIAL CAMPAIGN	MAINTENANCE CYCLES					
Base drawing/ photograph	June 2005						
Data Form No.1 – Identification	June 2005						
Building plan and overall photograph	June 2005						
Data Form No. 2 – Previous Interventions	June 2005						
Map and Legend – Previous Interventions	June 2005						
Data Form No. 3 – Condition Assessment	June 2005						
Map and Legend – Condition Assessment Map No. 1	June 2005						
Map and Legend – Condition Assessment Map No. 2	June 2005						
Map and Legend – Condition Assessment Map No. 3	June 2005						
Map and Legend – Condition Assessment Map No. 4	June 2005						
Data Form No. 4 – Intervention Planning	June 2005						
Data Form No. 5 – Current Interventions	October 2005						
Map and Legend – Current Interventions	October 2005						
Printed photographs							
Photograph Maps							
Revised base drawing/photograph							

ARCHIVING DATA

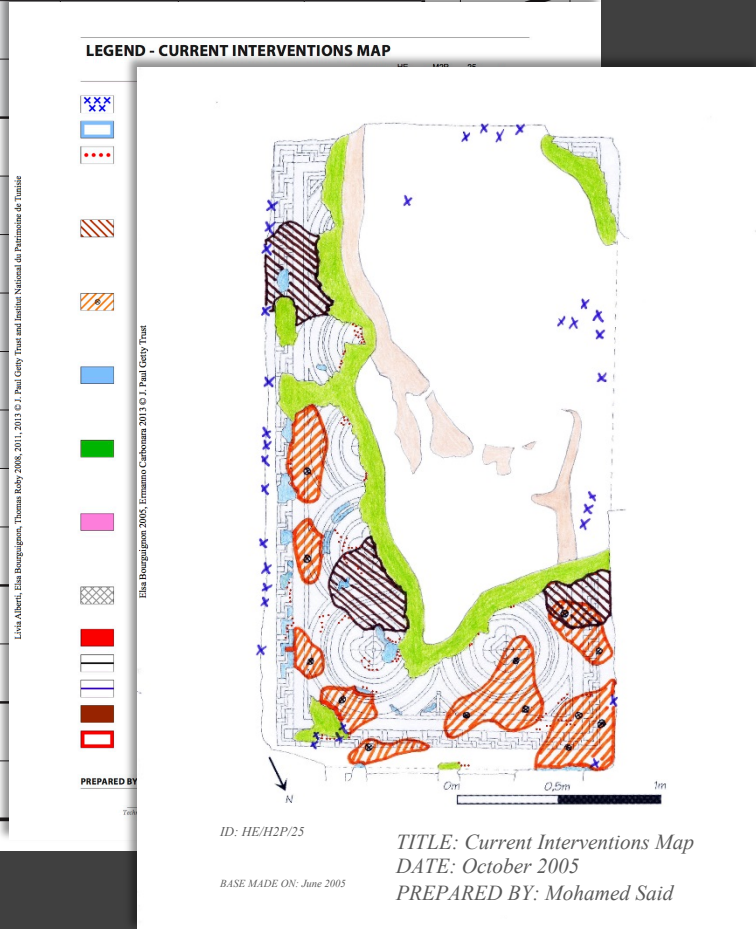

	DATES OF COMPLETION (month and year)			
	INITIAL CAMPAIGN			
Base drawing/photograph	June 2005			
Data Form No.1 – Identification	June 2005			
Building plan and overall photograph	June 2005			
Data Form No. 2 – Previous Interventions	June 2005			
Map and Legend – Previous Interventions	June 2005			
Data Form No. 3 – Condition Assessment	June 2005			
Map and Legend – Condition Assessment Map No. 1	June 2005			
Map and Legend – Condition Assessment Map No. 2	June 2005			
Map and Legend – Condition Assessment Map No. 3	June 2005			
Map and Legend – Condition Assessment Map No. 4	June 2005			
Data Form No. 4 – Intervention Planning	June 2005			
Data Form No. 5 – Current Interventions	October 2005			
Map and Legend – Current Interventions	October 2005			
Printed photographs	June 2005			
Photograph Maps	June 2005			
Revised base drawing/photograph				

Elsa Bourgaignon 2005, Ermanno Carbonara 2013 © J. Paul Getty Trust

ID: HE/H2P/25

BASE MADE ON: June 2005

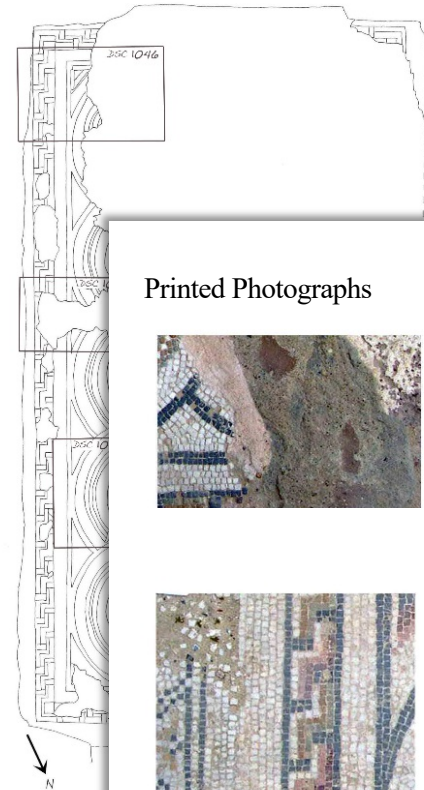

Printed Photographs

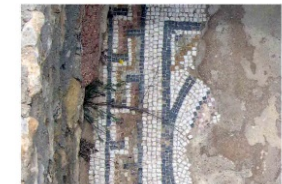
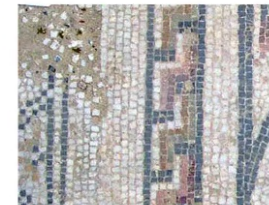

JUNE 2005

	DATES OF COMPLETION			
	INITIAL CAMPAIGN			
Base drawing/photograph	June 2005			
Data Form No.1 – Identification	June 2005			
Building plan and overall photograph	June 2005			
Data Form No. 2 – Previous Interventions	June 2005			
Map and Legend – Previous Interventions	June 2005			
Data Form No. 3 – Condition Assessment	June 2005	July 2006		
Map and Legend – Condition Assessment Map No. 1	June 2005			
Map and Legend – Condition Assessment Map No. 2	June 2005			
Map and Legend – Condition Assessment Map No. 3	June 2005			
Map and Legend – Condition Assessment Map No. 4	June 2005			
Data Form No. 4 – Intervention Planning	June 2005			
Data Form No. 5 – Current Interventions	October 2005			
Map and Legend – Current Interventions	October 2005			
Printed photographs	June 2005			
Photograph Maps	June 2005			
Revised base drawing/photograph				

Livia Alberti, Elsa Bourgaignon, Thomas Roby 2008, 2011, 2013 © J. Paul Getty Trust and Institut National du Patrimoine de Tunisie

DATA FORM NO. 3 – CONDITION ASSESSMENT

STUDY PHASE

MOSAIC ID HE H2P / 25 / _____

INSPECTION TYPE Initial inspection Maintenance cycle

PRESENT EXPOSURE CONDITIONS

- In open air Reburied Under an open shelter
- Walked on Under a removable cover Under a closed shelter
- Parts not excavated or inaccessible

During the initial inspection, check the boxes of all the deterioration phenomena that are present. During maintenance cycles, only indicate new deterioration phenomena that have occurred since the last inspection or last intervention.

STRUCTURAL DETERIORATION

(Condition Assessment Map No. 1)

- Tessellatum lacunae Depressions
- Cracks Detachments between mosaic layers
- Bulges

SURFACE DETERIORATION

(Condition Assessment Map No. 2)

- Detached tesserae Stains
- Deteriorated tesserae Incrustations
- Deteriorated mortar between tesserae Efflorescence

PRESENCE OF BIO-DETERIORATION AGENTS

(Condition Assessment Map No. 3)

- Micro-organisms Tunnels or entrance holes made by insects and other animals
- Vegetation

DETERIORATION OF INTERVENTIONS

(Condition Assessment Map No. 4)

- Deteriorated lacunae fills or edging repairs Re-detached tesserae
- Deteriorated mortar between tesserae Deteriorated support panels
- Deteriorated support metal reinforcements
- Reburial:** Presence of vegetation
- Loss of fill materials
- Deteriorated separation membranes

DETERIORATION OF INTERVENTIONS AROUND THE MOSAIC

- Clogged drainage Deteriorated cover or shelter
- Stabilized walls with new deterioration Damaged access barrier
- Other: _____

OBSERVATIONS ON THE CONDITION ASSESSMENT

New deterioration is not serious. There is a large accumulation of dirt and wall mortar powder on the edges of the mosaic.

GENERAL CONDITION OF THE MOSAIC

- Good** Fair Bad
- Date recommended for next inspection: Within 6 months
(No intervention required)
- Date recommended for intervention: _____
(Intervention required)

PREPARED BY Mohamed Said DATE July 2006

	DATES OF COMPLETION			
	INITIAL CAMPAIGN			
Base drawing/photograph	June 2005			
Data Form No.1 – Identification	June 2005			
Building plan and overall photograph	June 2005			
Data Form No. 2 – Previous Interventions	June 2005			
Map and Legend – Previous Interventions	June 2005			
Data Form No. 3 – Condition Assessment	June 2005	July 2006	April 2010	
Map and Legend – Condition Assessment Map No. 1	June 2005			
Map and Legend – Condition Assessment Map No. 2	June 2005			
Map and Legend – Condition Assessment Map No. 3	June 2005			
Map and Legend – Condition Assessment Map No. 4	June 2005			
Data Form No. 4 – Intervention Planning	June 2005			
Data Form No. 5 – Current Interventions	October 2005			
Map and Legend – Current Interventions	October 2005			
Printed photographs	June 2005			
Photograph Maps	June 2005			
Revised base drawing/photograph				

Livia Alberti, Elsa Bourgaignon, Thomas Roby 2008, 2011, 2013 © J. Paul Getty Trust and Institut National du Patrimoine de Tunisie

DATA FORM NO. 3 – CONDITION ASSESSMENT

STUDY PHASE

MOSAIC ID HE H2P / 25 / _____

INSPECTION TYPE Initial inspection Maintenance cycle

PRESENT EXPOSURE CONDITIONS

- In open air Reburied Under an open shelter
- Walked on Under a removable cover Under a closed shelter
- Parts not excavated or inaccessible

During the initial inspection, check the boxes of all the deterioration phenomena that are present. During maintenance cycles, only indicate new deterioration phenomena that have occurred since the last inspection or last intervention.

STRUCTURAL DETERIORATION

(Condition Assessment Map No. 1)

- Tessellatum lacunae Depressions
- Cracks Detachments between mosaic layers
- Bulges

SURFACE DETERIORATION

(Condition Assessment Map No. 2)

- Detached tesserae Stains
- Deteriorated tesserae Incrustations
- Deteriorated mortar between tesserae Efflorescence

PRESENCE OF BIO-DETERIORATION AGENTS

(Condition Assessment Map No. 3)

- Micro-organisms Tunnels or entrance holes made by insects and other animals
- Vegetation

DETERIORATION OF INTERVENTIONS

(Condition Assessment Map No. 4)

- Deteriorated lacunae fills or edging repairs Re-detached tesserae
 - Deteriorated mortar between tesserae Deteriorated support panels
 - Deteriorated support metal reinforcements
- Reburial:** Presence of vegetation
 Loss of fill materials
 Deteriorated separation membranes

DETERIORATION OF INTERVENTIONS AROUND THE MOSAIC

- Clogged drainage Deteriorated cover or shelter
- Stabilized walls with new deterioration Damaged access barrier
- Other: _____

OBSERVATIONS ON THE CONDITION ASSESSMENT

GENERAL CONDITION OF THE MOSAIC

- Good Fair Bad

- Date recommended for next inspection: _____
(No intervention required)
- Date recommended for intervention: Within 2 months
(Intervention required)

PREPARED BY Mohamed Said DATE April 2010

	DATES OF COMPLETION (month and year)			
	INITIAL CAMPAIGN	MAINTENANCE CYCLES		
Base drawing/ photograph	June 2005			
Data Form No.1 – Identification	June 2005			
Building plan and overall photograph	June 2005			
Data Form No. 2 – Previous Interventions	June 2005			
Map and Legend – Previous Interventions	June 2005			
Data Form No. 3 – Condition Assessment	June 2005	July 2006	April 2010	
Map and Legend – Condition Assessment Map No. 1	June 2005			
Map and Legend – Condition Assessment Map No. 2	June 2005			
Map and Legend – Condition Assessment Map No. 3	June 2005			
Map and Legend – Condition Assessment Map No. 4	June 2005			
Data Form No. 4 – Intervention Planning	June 2005			
Data Form No. 5 – Current Interventions	October 2005			
Map and Legend – Current Interventions	October 2005			
Printed photographs	June 2005			
Photograph Maps	June 2005			
Revised base drawing /photograph			April 2010	

ARCHIVI



ID: HE/H2P/25

TITLE:
DATE:

BASE MADE ON: April 2010

PREPARED BY:

	DATES OF COMPLETION			
	INITIAL CAMPAIGN	MAY		
Base drawing/ photograph	June 2005			
Data Form No.1 – Identification	June 2005			
Building plan and overall photograph	June 2005			
Data Form No. 2 – Previous Interventions	June 2005			
Map and Legend – Previous Interventions	June 2005			
Data Form No. 3 – Condition Assessment	June 2005	July 2006	April 2010	
Map and Legend – Condition Assessment Map No. 1	June 2005			
Map and Legend – Condition Assessment Map No. 2	June 2005			
Map and Legend – Condition Assessment Map No. 3	June 2005			
Map and Legend – Condition Assessment Map No. 4	June 2005			
Data Form No. 4 – Intervention Planning	June 2005			
Data Form No. 5 – Current Interventions	October 2005		June 2010	
Map and Legend – Current Interventions	October 2005			
Printed photographs	June 2005			
Photograph Maps	June 2005			
Revised base drawing /photograph			April 2010	

Livia Alberti, Elsa Bourgaignon, Thomas Roby 2008, 2011, 2013 © J. Paul Getty Trust and Institut National du Patrimoine de Tunisie

DATA FORM NO. 5 - CURRENT INTERVENTIONS

MOSAIC ID *HE H2P 25* INTERVENTION PHASE
 _____/_____/_____/_____

INTERVENTION TYPE Initial intervention Maintenance cycle

DATE OF PREVIOUS INTERVENTION *October 2006*

DATE OF PREVIOUS INSPECTION *July 2006*

DATE AND LENGTH OF CURRENT WORK *June 2010 - 5 days*

DATE RECOMMENDED FOR THE NEXT INSPECTION *June 2011*

TREATMENTS CARRIED OUT ON THE MOSAIC

- Vegetation removal
- Cleaning of the entire surface
- Cleaning of part of the surface
- Removal of modern repair mortars
- Resetting tesserae
- Filling interstices between tesserae
- Grouting voids between preparatory layers
- Infilling lacunae and/or edging repairs
- Removal and resetting tesserae with facing
- Removal of metal reinforcements in support panels
- Treatment of metal reinforcements in support panels
- Drainage
- Reburial (Draw a vertical section of the reburial: describe the fill materials and separation membranes used, provide the total thickness and the thickness of each layer)

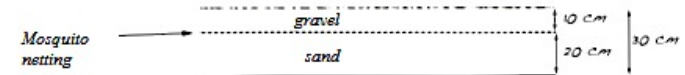

Wooden planks for containing reburial materials.

INTERVENTIONS CARRIED OUT AROUND THE MOSAIC

- Wall stabilization
Notes:
- Other: _____
Notes:















NAMES OF THE TECHNICIANS WHO CARRIED OUT THE WORK *Mohamed Said and Nouredine Jaziri*

PREPARED BY *Mohamed Said* DATE *June 2010*

	DATES OF COMPLETION (month and year)			
	INITIAL CAMPAIGN	MAINTENANCE CYCLES		
Base drawing/ photograph	June 2005			
Data Form No.1 – Identification	June 2005			
Building plan and overall photograph	June 2005			
Data Form No. 2 – Previous Interventions	June 2005			
Map and Legend – Previous Interventions	June 2005			
Data Form No. 3 – Condition Assessment	June 2005	July 2006	April 2010	
Map and Legend – Condition Assessment Map No. 1	June 2005			
Map and Legend – Condition Assessment Map No. 2	June 2005			
Map and Legend – Condition Assessment Map No. 3	June 2005			
Map and Legend – Condition Assessment Map No. 4	June 2005			
Data Form No. 4 – Intervention Planning	June 2005			
Data Form No. 5 – Current Interventions	October 2005		June 2010	
Map and Legend – Current Interventions	October 2005		June 2010	
Printed photographs	June 2005			
Photograph Maps	June 2005			
Revised base drawing /photograph			April 2010	

ARCHIVING DA

LEGEND - CURRENT INTERVENTIONS MAP

-  Vegetation
-  Cleaning of
-  Resetting t
Mortar com
1 - Lime Pun
-  Filling inter
Mortar com
1 - Lime Pun
-  Grouting v
Mortar com
1 - Hydraulic
-  Infilling of
Mortar com
-  Infilling of
Mortar com
-  Infilling of
Mortar com
-  Facing wit
-  Removal a
-  Removal o
-  Treatment
-  Drainage o
-  Reburial o

PREPARED BY Mohamed Said



ID: HE/H2P/25

BASE MADE ON: April 2010

TITLE: *Current Interventions Map*

DATE: June 2010

PREPARED BY: Mohamed Said

	DATES OF COMPLETION (month and year)			
	INITIAL CAMPAIGN	MAINTENANCE CYCLES		
Base drawing/ photograph	June 2005			
Data Form No.1 – Identification	June 2005			
Building plan and overall photograph	June 2005			
Data Form No. 2 – Previous Interventions	June 2005			
Map and Legend – Previous Interventions	June 2005			
Data Form No. 3 – Condition Assessment	June 2005	July 2006	April 2010	
Map and Legend – Condition Assessment Map No. 1	June 2005			
Map and Legend – Condition Assessment Map No. 2	June 2005			
Map and Legend – Condition Assessment Map No. 3	June 2005			
Map and Legend – Condition Assessment Map No. 4	June 2005			
Data Form No. 4 – Intervention Planning	June 2005			
Data Form No. 5 – Current Interventions	October 2005		June 2010	
Map and Legend – Current Interventions	October 2005		June 2010	
Printed photographs	June 2005		June 2010	
Photograph Maps	June 2005			
Revised base drawing /photograph			April 2010	

ARCHIVIN



Livia Alberti 2012 © J. Paul Getty Trust

HE-H2P-25_2010-06_5IR_Reburial

	DATES OF COMPLETION (month and year)			
	INITIAL CAMPAIGN			MAINTENANCE
Base drawing/ photograph	June 2005			
Data Form No.1 – Identification	June 2005			
Building plan and overall photograph	June 2005			
Data Form No. 2 – Previous Interventions	June 2005			
Map and Legend – Previous Interventions	June 2005			
Data Form No. 3 – Condition Assessment	June 2005	July 2006	April 2010	April 2011
Map and Legend – Condition Assessment Map No. 1	June 2005			
Map and Legend – Condition Assessment Map No. 2	June 2005			
Map and Legend – Condition Assessment Map No. 3	June 2005			
Map and Legend – Condition Assessment Map No. 4	June 2005			
Data Form No. 4 – Intervention Planning	June 2005			
Data Form No. 5 – Current Interventions	October 2005		June 2010	
Map and Legend – Current Interventions	October 2005		June 2010	
Printed photographs	June 2005		June 2010	
Photograph Maps	June 2005			
Revised base drawing /photograph			April 2010	

Livia Alberici, Elsa Bourgaignon, Thomas Roby 2008, 2011, 2013 © J. Paul Getty Trust and Institut National du Patrimoine de Tunisie

DATA FORM NO. 3 – CONDITION ASSESSMENT

STUDY PHASE

MOSAIC ID HE / H2P 25 /

INSPECTION TYPE Initial inspection Maintenance cycle

PRESENT EXPOSURE CONDITIONS

- In open air Reburied Under an open shelter
 Walked on Under a removable cover Under a closed shelter
 Parts not excavated or inaccessible

During the initial inspection, check the boxes of all the deterioration phenomena that are present. During maintenance cycles, only indicate new deterioration phenomena that have occurred since the last inspection or last intervention.

STRUCTURAL DETERIORATION

(Condition Assessment Map No. 1)

- Tessellatum lacunae Depressions
 Cracks Detachments between mosaic layers
 Bulges

SURFACE DETERIORATION

(Condition Assessment Map No. 2)

- Detached tesserae Stains
 Deteriorated tesserae Incrustations
 Deteriorated mortar between tesserae Efflorescence

PRESENCE OF BIO-DETERIORATION AGENTS

(Condition Assessment Map No. 3)

- Micro-organisms Tunnels or entrance holes made by insects and other animals
 Vegetation

DETERIORATION OF INTERVENTIONS

(Condition Assessment Map No. 4)

- Deteriorated lacunae fills or edging repairs Re-detached tesserae
 Deteriorated mortar between tesserae Deteriorated support panels
 Deteriorated support metal reinforcements
Reburial: Presence of vegetation
 Loss of fill materials
 Deteriorated separation membranes

DETERIORATION OF INTERVENTIONS AROUND THE MOSAIC

- Clogged drainage Deteriorated cover or shelter
 Stabilized walls with new deterioration Damaged access barrier
 Other: _____

OBSERVATIONS ON THE CONDITION ASSESSMENT

Due to presence of vegetation, the reburial should be made part of the schedule of vegetation removal for the site.

GENERAL CONDITION OF THE MOSAIC

Good Fair Bad

Date recommended for next inspection: _____
(No intervention required)

Date recommended for intervention: Within 12 months
(Intervention required)

PREPARED BY Mohamed Said

DATE April 2011

ARCHIVING DATA FORM

SITE NAME HERGLA

MOSAICID HE / H2P / 25 /

	DATES OF COMPLETION (month and year)							
	INITIAL CAMPAIGN	MAINTENANCE CYCLES						
Base drawing/ photograph	June 2005							
Data Form No.1 – Identification	June 2005							
Building plan and overall photograph	June 2005							
Data Form No. 2 – Previous Interventions	June 2005							
Map and Legend – Previous Interventions	June 2005							
Data Form No. 3 – Condition Assessment	June 2005	July 2006	April 2010	April 2011				
Map and Legend – Condition Assessment Map No. 1	June 2005							
Map and Legend – Condition Assessment Map No. 2	June 2005							
Map and Legend – Condition Assessment Map No. 3	June 2005							
Map and Legend – Condition Assessment Map No. 4	June 2005							
Data Form No. 4 – Intervention Planning	June 2005							
Data Form No. 5 – Current Interventions	October 2005		June 2010					
Map and Legend – Current Interventions	October 2005		June 2010					
Printed photographs	June 2005		June 2010					
Photograph Maps	June 2005							
Revised base drawing /photograph			April 2010					

Archiving of digital documentation

The naming of digital files

The file name should consist of the following, comprised of 5 parts:

DG-Th1-11-2_2006-05-10_3CA_DetachTess_04

Mosaic ID	Date	Subject		Number
		Category	Note	
Site – Building – Room - Division	yyyy-mm-dd	<ul style="list-style-type: none"> • 1ID (Identification) • 2PI (Previous Interventions) • 3CA (Condition Assessment) • 4PL (Planning) • 5CI (Current Interventions) • 6WA (Working Aid) 	(Use the technical vocabulary found in the map legends and the <i>Illustrated Glossary</i>)	(If two files share the same ID, date, subject and format)
Example				
DG – Th1 – 11 – 2	2006–05-10	3CA	DetachTess	04

Organization of digital folders

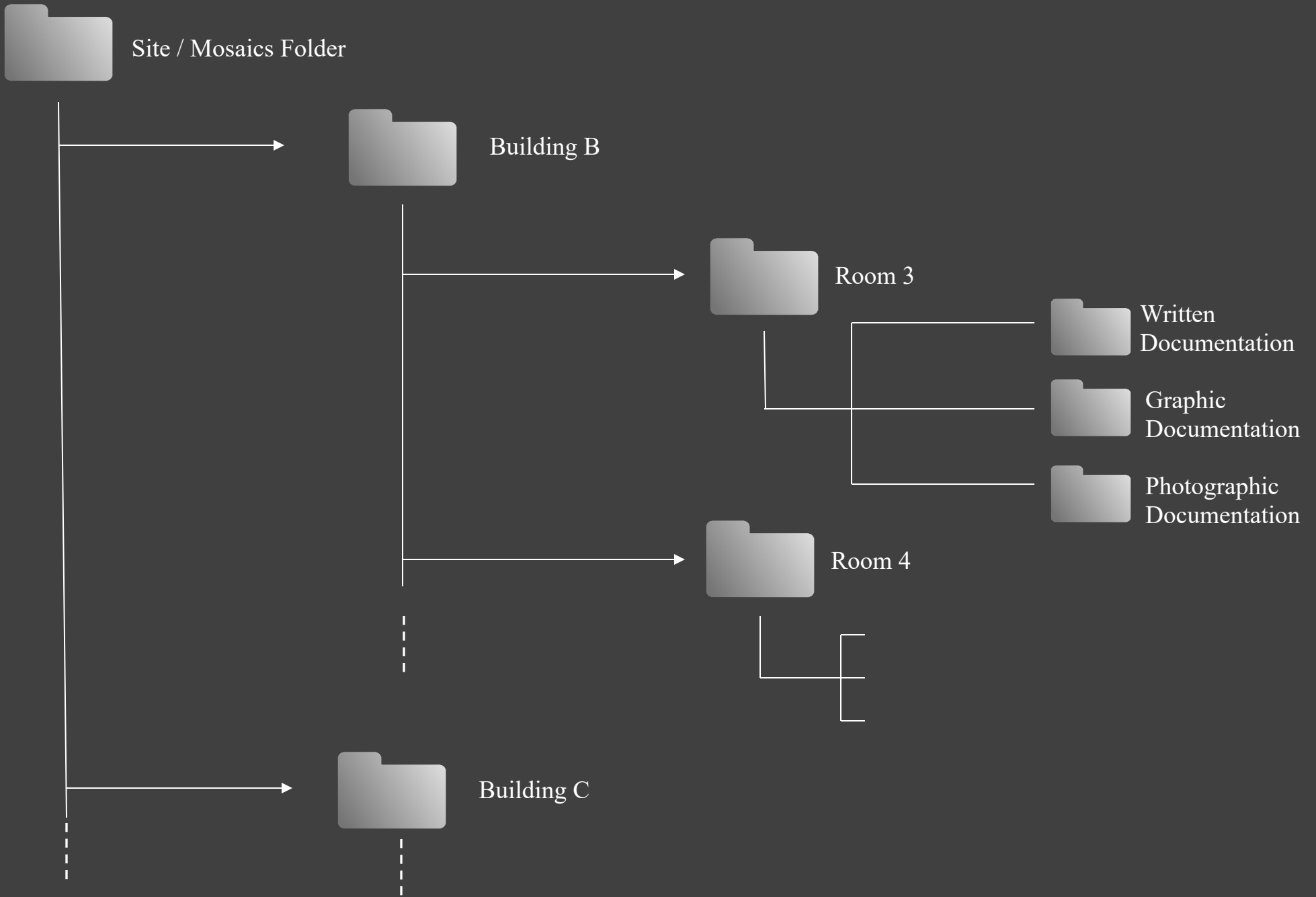

CASE STUDY

Hergla, Tunisia

House « of the two peristyles »

ID: HE/H2P/25

Complete example of
digital documentation



Hergla (HE)
/ MOSAICS FOLDER

House 'of the two peristyles'
(H2P)

Room 25
(25)

Written
Documentation

HE-H2P-25_2005-06_1ID_DataForm.pdf
HE-H2P-25_2005-06_2PI_DataForm.pdf
HE-H2P-25_2005-06_3CA_DataForm.pdf
HE-H2P-25_2005-06_4PL_DataForm.pdf
HE-H2P-25_2005-10_5CI_DataForm.pdf
HE-H2P-25_2006-07_3CA_DataForm.pdf
HE-H2P-25_2010-04_3CA_DataForm.pdf
HE-H2P-25_2010-10_5CI_DataForm.pdf
HE-H2P-25_2011-04_3CA_DataForm.pdf

Graphic
Documentation

HE-H2P-25_2005-06-17_1ID_BuildingPlan.jpg
HE-H2P-25_2005-06_2PI_Plan.pdf
HE-H2P-25_2005-06_2PI_DigitalPlan.pdf
HE-H2P-25_2005-06_2PI_Legend.pdf
HE-H2P-25_2005-06_3CA_Plan1.pdf
HE-H2P-25_2005-06_3CA_DigitalPlan1.pdf
HE-H2P-25_2005-06_3CA_Legend1.pdf
HE-H2P-25_2005-06_3CA_Plan2.pdf
HE-H2P-25_2005-06_3CA_DigitalPlan2.pdf
HE-H2P-25_2005-06_3CA_Legend2.pdf
HE-H2P-25_2005-06_3CA_Plan3.pdf
HE-H2P-25_2005-06_3CA_DigitalPlan3.pdf
HE-H2P-25_2005-06_3CA_Legend3.pdf
HE-H2P-25_2005-06_3CA_Plan4.pdf
HE-H2P-25_2005-06_3CA_DigitalPlan4.pdf
HE-H2P-25_2005-06_3CA_Legend4.pdf

.....

Photographic
Documentation

HE-H2P-25_2005-06-17_1ID_GeneralView.doc
HE-H2P-25_2005-06-17_1ID_GeneralView.jpg
HE-H2P-25_2005-06_2PI_MortarRepairsDSC1045.jpg
HE-H2P-25_2005-06_3CA_DeterioratedFillingLacunaeDSC1043.jpg
HE-H2P-25_2005-06_3CA_DetachedTessDSC1047.jpg
HE-H2P-25_2005-06_3CA_DeterioratedTessDSC1044.jpg
HE-H2P-25_2005-06_3CA_DeterioratedTessDSC1048.jpg
HE-H2P-25_2005-06_3CA_VegetationDSC1046.jpg
HE-H2P-25_2010-10_5CI_Reburial.jpg

HE-H2P-25_2005-06_1ID_DataForm.pdf

HE-H2P-25_2005-06_2PI_DataForm.pdf

HE-H2P-25_2005-06_3CA_DataForm.pdf

HE-H2P-25_2005-06_4PL_DataForm.pdf

HE-H2P-25_2005-10_5CI_DataForm.pdf

HE-H2P-25_2006-07_3CA_DataForm.pdf

HE-H2P-25_2010-04_3CA_DataForm.pdf

HE-H2P-25_2010-10_5CI_DataForm.pdf

HE-H2P-25_2011-04_3CA_DataForm.pdf

DATA FORM NO. 1 – IDENTIFICATION

STUDY PHASE

MOSAIC ID HE / H2P / 25 / _____

This form must be completed with the site manager. It should be supplemented by an overall photograph of the mosaic and a plan of the building indicating the location of the room.

SITE *Hergla (HE)*

BUILDING *House "of the Two Peristyles" (H2P)*

ROOM *25*

SECTIONS, FRAGMENTS OR LEVELS

(Use Arabic numerals for sections, letters for fragments, Roman numerals for levels)

MOSAIC ID HE / H2P / 25 / _____
(Abbreviation of the site / building / room / sections or fragments or levels)

EXISTING DOCUMENTATION ABOUT THE MOSAIC AND ITS CONSERVATION

(References of publications, plans, photographs, drawings and other documents)

Map of building from INP archives in Tunis

DATE OF MOSAIC EXCAVATION: _____

DIMENSIONS AND NUMBERING OF SECTIONS, FRAGMENTS OR LEVELS

(Use an existing drawing or make a sketch of the mosaic indicating the north and the walls of the room)

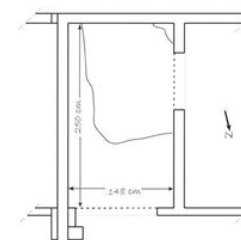

GENERAL OBSERVATIONS ON THE CONSTRUCTION TECHNIQUE

(Type of pavement, decoration, materials, colors, tesserae sizes, etc.)

Pavement in Opus Tessellatum, polychrome geometric tesserae in white, black, green, yellow, pink, and red limestone. Dimensions of the tesserae: 0.80cm x 1.00cm; 1.00cm x 1.00cm; 1.20cm x 1.00cm

PREPARED BY *Mohamed Said*

DATE *June 2005*

Written Documentation

HE-H2P-25_2005-06_1ID_DataForm.pdf
HE-H2P-25_2005-06_2PI_DataForm.pdf
HE-H2P-25_2005-06_3CA_DataForm.pdf
HE-H2P-25_2005-06_4PL_DataForm.pdf
HE-H2P-25_2005-10_5CI_DataForm.pdf
HE-H2P-25_2006-07_3CA_DataForm.pdf
HE-H2P-25_2010-04_3CA_DataForm.pdf
HE-H2P-25_2010-10_5CI_DataForm.pdf
HE-H2P-25_2011-04_3CA_DataForm.pdf

Livia Alberti, Elsa Bourguignon, Thomas Roby 2008, 2011, 2013 © J. Paul Getty Trust and Institut National du Patrimoine de Tunisie

DATA FORM NO. 2 – PREVIOUS INTERVENTIONS

STUDY PHASE
MOSAIC ID HE/H2P/25

PREVIOUS INTERVENTIONS ON THE MOSAIC

- Mortar repairs Infilling of lacunae
 Edging repair
 Filling of interstices between tesserae
 Grouting of voids between preparatory layers
- Reintegration of lacunae with tesserae
 with pieces of stone, brick or other material inserted into the mortar
- Lifting and relaying on a new support Reinforced concrete/cement support
 Other type of support: _____
- Surface treatment Chemical cleaning
 Mechanical abrasion
 Application of a surface product (resin, wax, etc.)
 Other: _____
- Parts detached and stored elsewhere
- Reburial (*Draw a vertical section of the reburial; describe the fill materials and separation membranes used, provide the total thickness and the thickness of each layer*)

PREVIOUS INTERVENTIONS AROUND THE MOSAIC

- Drainage Open shelter Wall stabilization
 Removable cover Closed shelter Other: _____
 Access barrier: _____

DATES OF PREVIOUS INTERVENTIONS CARRIED OUT AND INFORMATION SOURCES

First: on discovery of the pavement by archaeologists in 1969.

Second: in the 1980s

Source: Mr. Hamza, site guard

PREPARED BY Mohamed Said

DATE June 2005

Graphic Documentation

- HE-H2P-25_2005-06-17_1ID_BuildingPlan.jpg
- HE-H2P-25_2005-06_2PI_Plan.pdf
- HE-H2P-25_2005-06_2PI_DigitalPlan.pdf
- HE-H2P-25_2005-06_2PI_Legend.pdf
- HE-H2P-25_2005-06_3CA_Plan1.pdf
- HE-H2P-25_2005-06_3CA_DigitalPlan1.pdf
- HE-H2P-25_2005-06_3CA_Legend1.pdf
- HE-H2P-25_2005-06_3CA_Plan2.pdf
- HE-H2P-25_2005-06_3CA_DigitalPlan2.pdf
- HE-H2P-25_2005-06_3CA_Legend2.pdf
- HE-H2P-25_2005-06_3CA_Plan3.pdf
- HE-H2P-25_2005-06_3CA_DigitalPlan3.pdf
- HE-H2P-25_2005-06_3CA_Legend3.pdf
- HE-H2P-25_2005-06_3CA_Plan4.pdf
- HE-H2P-25_2005-06_3CA_DigitalPlan4.pdf
- HE-H2P-25_2005-06_3CA_Legend4.pdf
- HE-H2P-25_2005-06_5CI_Plan.pdf
- HE-H2P-25_2005-06_5CI_DigitalPlan.pdf
- HE-H2P-25_2005-06_5CI_Legend.pdf
- HE-H2P-25_2005-06_DocGraphicPlans.psd**
- HE-H2P-25_2010-10_5CI_Plan.pdf
- HE-H2P-25_2010-10_5CI_DigitalPlan.pdf
- HE-H2P-25_2010-10_5CI_Legend.pdf

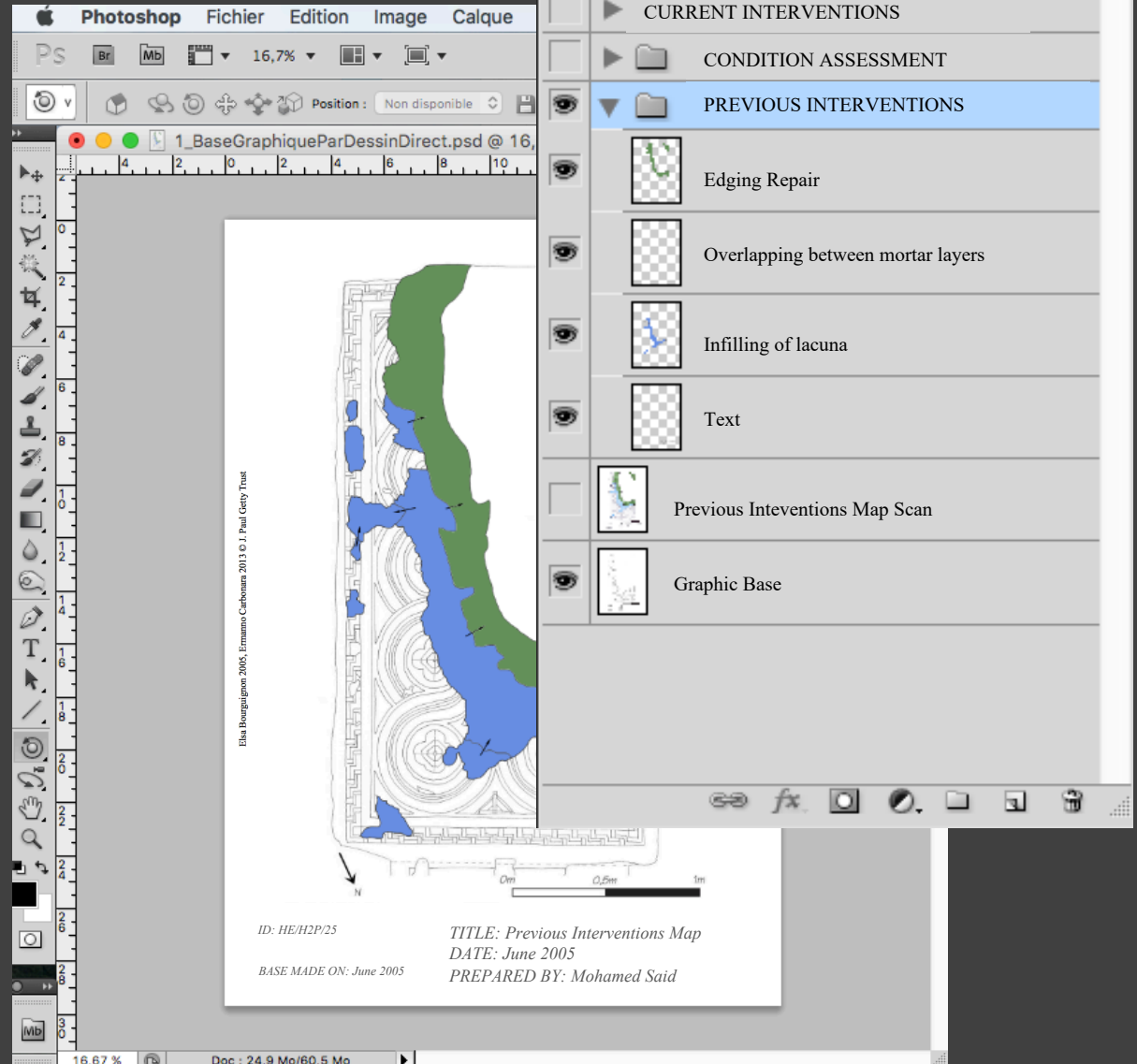

Graphic Documentation

HE-H2P-25_2005-06-17_1ID_BuildingPlan.jpg

HE-H2P-25_2005-06_2PI_Plan.pdf

HE-H2P-25_2005-06_2PI_DigitalPlan.pdf

HE-H2P-25_2005-06_2PI_Legend.pdf

HE-H2P-25_2005-06_3CA_Plan1.pdf

HE-H2P-25_2005-06_3CA_DigitalPlan1.pdf

HE-H2P-25_2005-06_3CA_Legend1.pdf

HE-H2P-25_2005-06_3CA_Plan2.pdf

HE-H2P-25_2005-06_3CA_DigitalPlan2.pdf

HE-H2P-25_2005-06_3CA_Legend2.pdf

HE-H2P-25_2005-06_3CA_Plan3.pdf

HE-H2P-25_2005-06_3CA_DigitalPlan3.pdf

HE-H2P-25_2005-06_3CA_Legend3.pdf

HE-H2P-25_2005-06_3CA_Plan4.pdf

HE-H2P-25_2005-06_3CA_DigitalPlan4.pdf

HE-H2P-25_2005-06_3CA_Legend4.pdf

HE-H2P-25_2005-06_5CI_Plan.pdf

HE-H2P-25_2005-06_5CI_DigitalPlan.pdf

HE-H2P-25_2005-06_5CI_Legend.pdf

HE-H2P-25_2005-06_DocGraphicPlans.psd

HE-H2P-25_2010-10_5CI_Plan.pdf

HE-H2P-25_2010-10_5CI_DigitalPlan.pdf

HE-H2P-25_2010-10_5CI_Legend.pdf

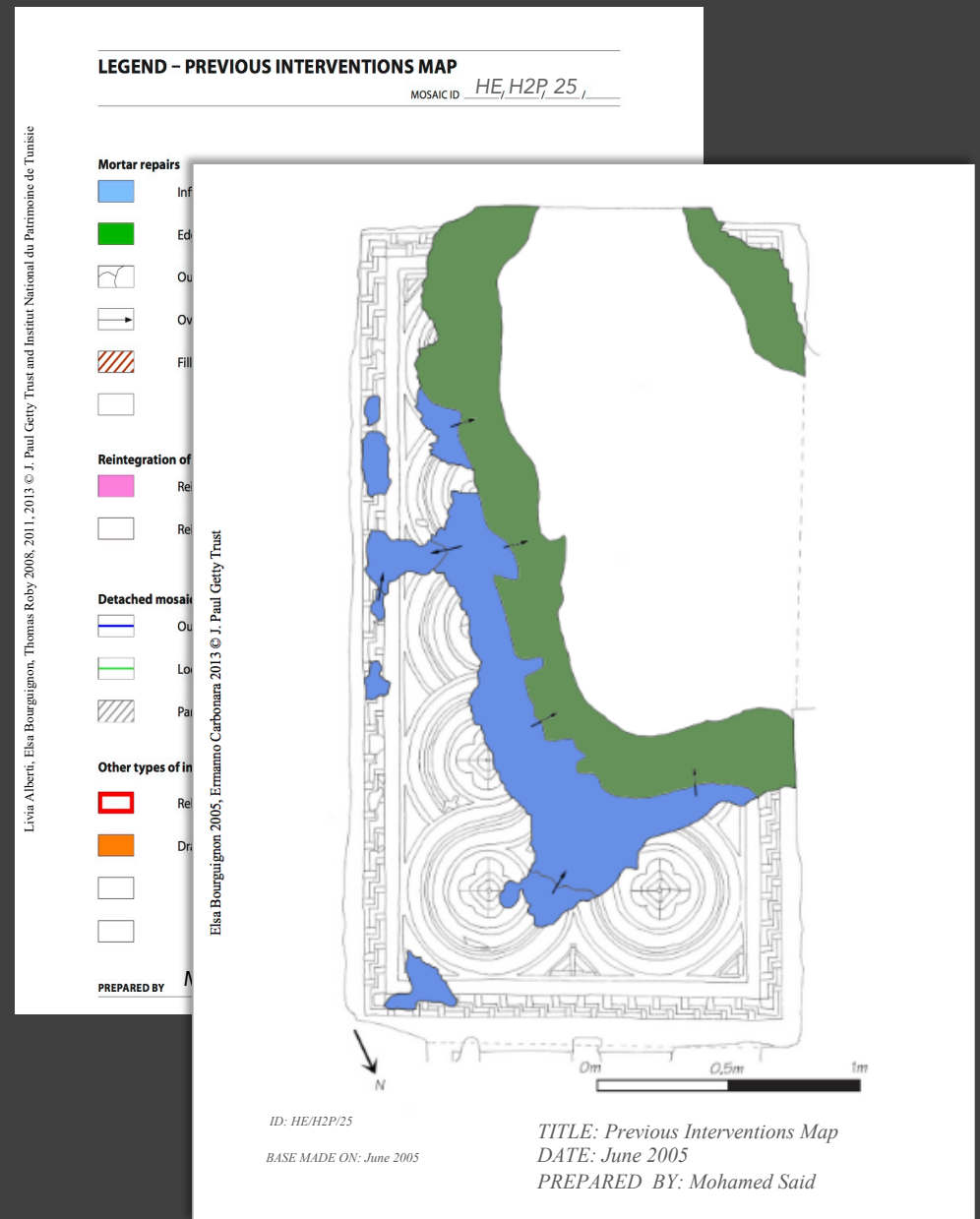

Graphic Documentation

HE-H2P-25_2005-06-17_1ID_BuildingPlan.jpg

HE-H2P-25_2005-06_2PI_Plan.pdf

HE-H2P-25_2005-06_2PI_DigitalPlan.pdf

HE-H2P-25_2005-06_2PI_Legend.pdf

HE-H2P-25_2005-06_3CA_Plan1.pdf

HE-H2P-25_2005-06_3CA_DigitalPlan1.pdf

HE-H2P-25_2005-06_3CA_Legend1.pdf

HE-H2P-25_2005-06_3CA_Plan2.pdf

HE-H2P-25_2005-06_3CA_DigitalPlan2.pdf

HE-H2P-25_2005-06_3CA_Legend2.pdf

HE-H2P-25_2005-06_3CA_Plan3.pdf

HE-H2P-25_2005-06_3CA_DigitalPlan3.pdf

HE-H2P-25_2005-06_3CA_Legend3.pdf

HE-H2P-25_2005-06_3CA_Plan4.pdf

HE-H2P-25_2005-06_3CA_DigitalPlan4.pdf

HE-H2P-25_2005-06_3CA_Legend4.pdf

HE-H2P-25_2005-06_5CI_Plan.pdf

HE-H2P-25_2005-06_5CI_DigitalPlan.pdf

HE-H2P-25_2005-06_5CI_Legend.pdf

HE-H2P-25_2005-06_DocGraphicPlans.psd

HE-H2P-25_2010-10_5CI_Plan.pdf

HE-H2P-25_2010-10_5CI_DigitalPlan.pdf

HE-H2P-25_2010-10_5CI_Legend.pdf

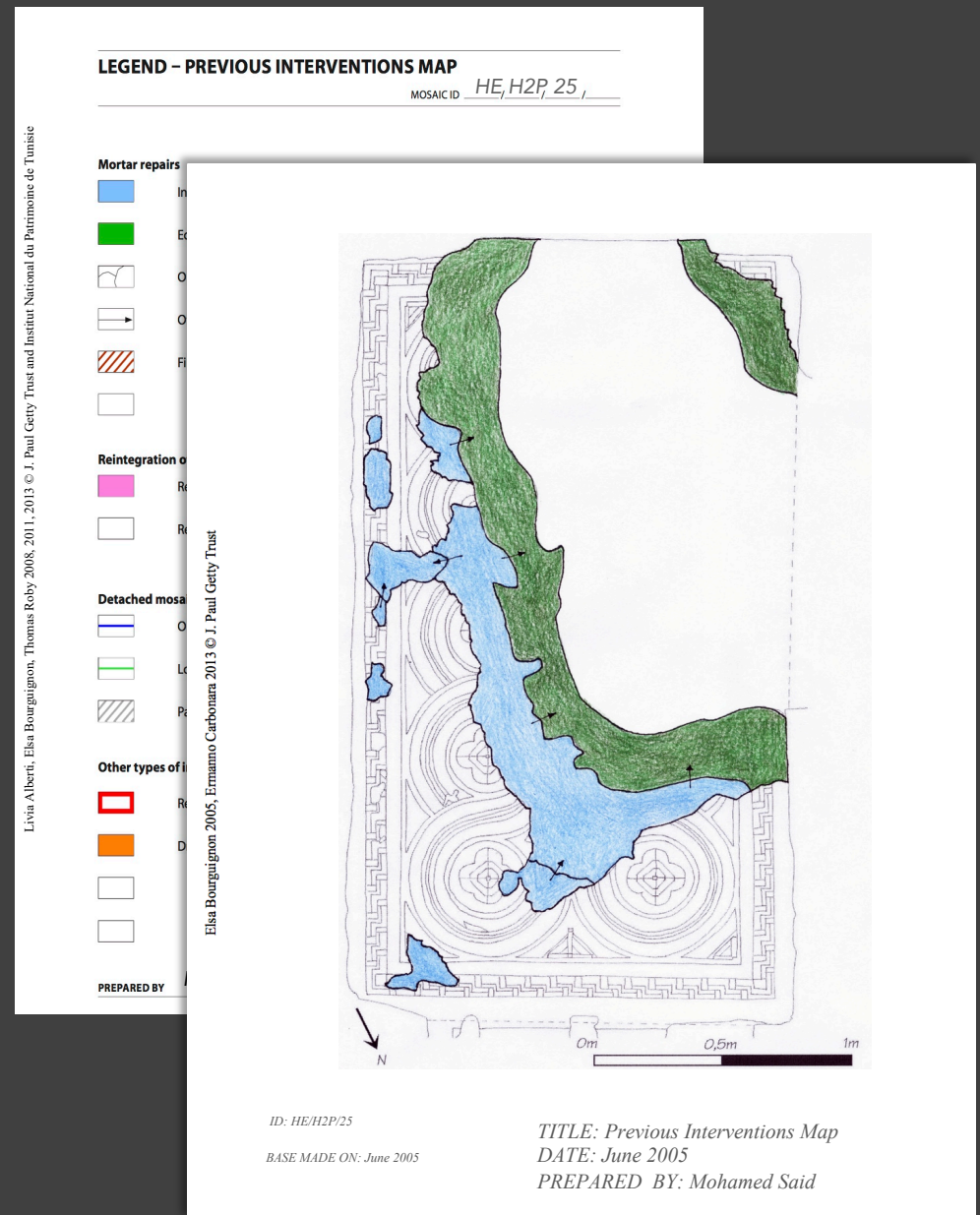

Photographic Documentation

HE-H2P-25_2005-06-17_1ID_GeneralView.doc

HE-H2P-25_2005-06-17_1ID_GeneralView.jpg

HE-H2P-25_2005-06_2PI_MortarRepairsDSC1045.jpg

HEH2P-25_2005-06_3CA_DeterioratedFillingLacunaeDSC1043.jpg

HE-H2P-25_2005-06_3CA_DetachedTessDSC1047.jpg

HE-H2P-25_2005-06_3CA_DeterioratedTessDSC1044.jpg

HE-H2P-25_2005-06_3CA_DeterioratedTessDSC1048.jpg

HE-H2P-25_2005-06_3CA_VegetationDSC1046.jpg

HE-H2P-25_2010-10_5CI_Reburial.jpg



HE-H2P-25_2005-06-17_1ID_GeneralView



Photographic Documentation

HE-H2P-25_2005-06-17_1ID_GeneralView.doc
HE-H2P-25_2005-06-17_1ID_GeneralView.jpg
HE-H2P-25_2005-06_2PI_MortarRepairsDSC1045.jpg
HEH2P-25_2005-06_3CA_DeterioratedFillingLacunaeDSC1043.jpg
HE-H2P-25_2005-06_3CA_DetachedTessDSC1047.jpg
HE-H2P-25_2005-06_3CA_DeterioratedTessDSC1044.jpg
HE-H2P-25_2005-06_3CA_DeterioratedTessDSC1048.jpg
HE-H2P-25_2005-06_3CA_VegetationDSC1046.jpg
HE-H2P-25_2010-10_5CI_Reburial.jpg





Photographic Documentation

HE-H2P-25_2005-06-17_1ID_GeneralView.doc
HE-H2P-25_2005-06-17_1ID_GeneralView.jpg
HE-H2P-25_2005-06_2PI_MortarRepairsDSC1045.jpg
HEH2P-25_2005-06_3CA_DeterioratedFillingLacunaeDSC1043.jpg
HE-H2P-25_2005-06_3CA_DetachedTessDSC1047.jpg
HE-H2P-25_2005-06_3CA_DeterioratedTessDSC1044.jpg
HE-H2P-25_2005-06_3CA_DeterioratedTessDSC1048.jpg
HE-H2P-25_2005-06_3CA_VegetationDSC1046.jpg
HE-H2P-25_2010-10_5CI_Reburial.jpg



Save all the files on an external hard drive which will be kept on site, in order to preserve for the long term digital images and documents.

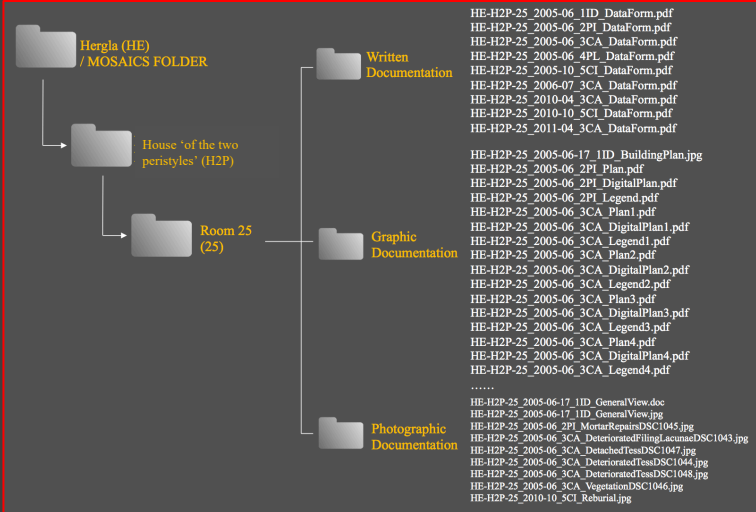

Ermanno Carbonara 2020 © J. Paul Getty Trust

Getty



MOSAIKON is a partnership of four institutions: the Getty Conservation Institute, the Getty Foundation, ICCROM, and ICCM. The aims of the project are to strengthen the network of professionals concerned with the conservation, restoration, maintenance, and management of mosaic heritage in the southern and eastern Mediterranean region; provide training to a variety of individuals involved in mosaics conservation and, more generally, with the management of archaeological sites and museums with mosaics; work with national and international bodies to provide a more favorable legislative, regulatory, and economic environment for the conservation of mosaics in the Mediterranean; and promote the dissemination and exchange of information.

